

Installation Instructions

Danza Collection

December 26, 2018

TUOHY

Table of Contents

Wall Panel & Shelving	1
Below Hutch Wall Panels & Task Lighting	2
Wall Hutches	3
Pedestals	4
L-Panel & T-Leg Supports	5
Modesty Panels - Removable	6
Modesty Panels - Horizontal Hinge	7
Modesty Panels - Vertical Hinge	8
Corner Shelving Tower	9
Divider Panels	10
Fixed Height Desks	11
Fixed Height Runoff Shells	12
Fixed Height Runoffs with Legs	13
Adjustable Height - Desks	14
Adjustable Height - Runoffs	15
Adjustable Height - Wall Hung Credenza	16
Wireless Round Dimmer Instructions	17
Face Adjustments / Drawer Installation / Removal	18

WALL PANELS & SHELVING

** Wall panel wood shelving support posts and 1/4" metal shelves must be installed in wall panel prior to securing wall panel to wall.

Wall Panel Shelving

Wood Shelving Support Posts:

1. Insert wood shelving support posts into allotted holes through back of wall panel.
2. Attach using #8 x 3/4" Flat Head Screws from back side of wall panel.

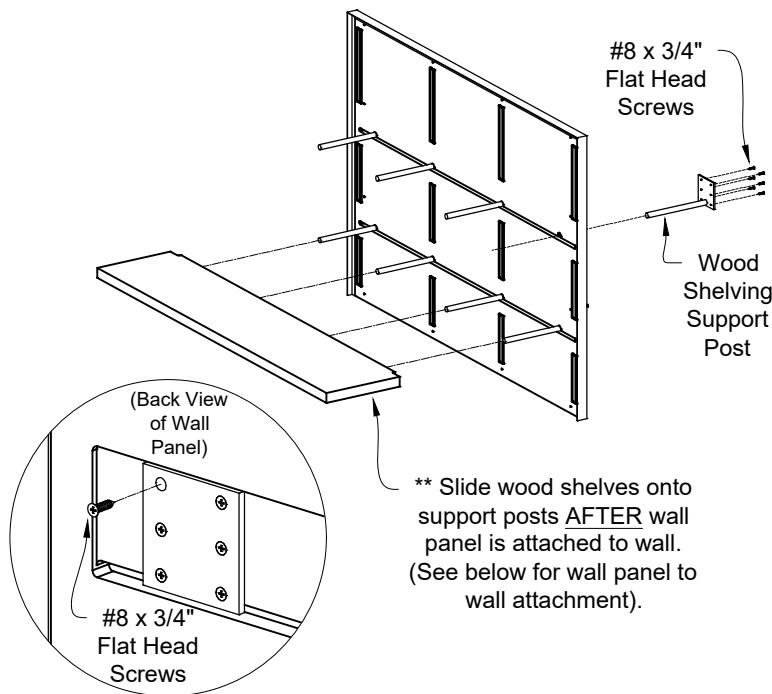

Metal Shelving:

1. Insert metal shelving into slot through front of wall panel and rotate down at the same time.
2. Attach shelf by screwing #8 x 3/4" Flat Head Screws through back of shelf into back of wall panel.

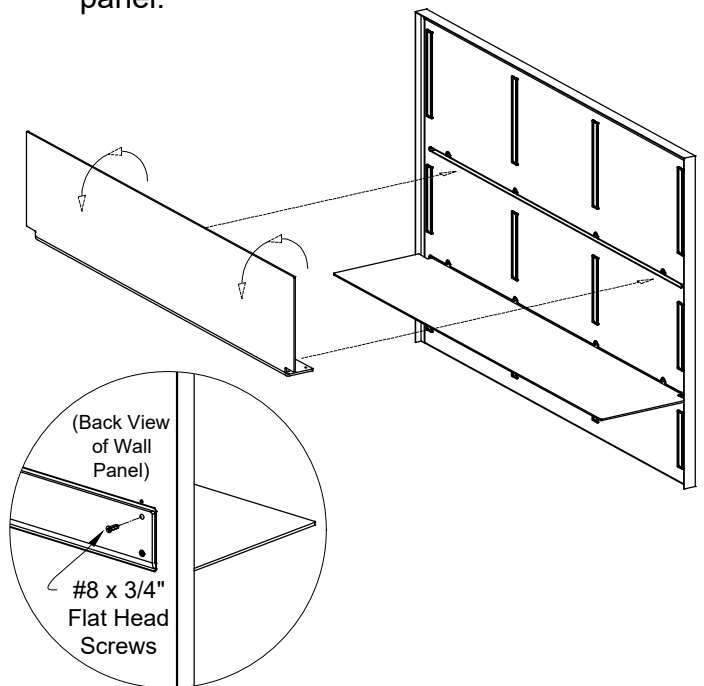

1. Attach french cleat to wall.
** To be used as installation aid only.
(Installer responsible for attachment hardware)
2. Secure wall panel to wall.
** Do NOT rely on french cleat only!
** Panel must be secured to wall throughout panel using the pre-drilled holes to obtain maximum shelf weight.
Toggle fasteners are recommended.
3. Fasten cover panels to secured wall panel using pre-installed Velcro strips.

French cleat to be installed as installation aid only. (Installer responsible for attachment hardware)

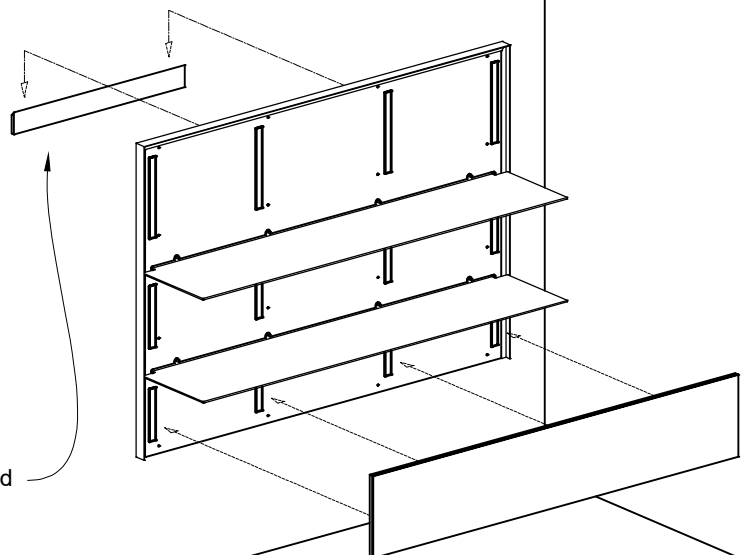

BELOW HUTCH WALL PANELS & TASK LIGHTING

** Wall panel wood shelving support posts and 1/4" metal shelves must be installed in wall panel prior to securing wall panel to wall. (See page 1)

1. Attach wall panel to wall (See page 1).
** Must install wall panel prior to installing hutches.
2. Attach hutch to wall (See page 3).
3. Chase wires down through notch in wall panel shelving.
4. Fasten cover panels to secured wall panel using pre-installed Velcro strips.

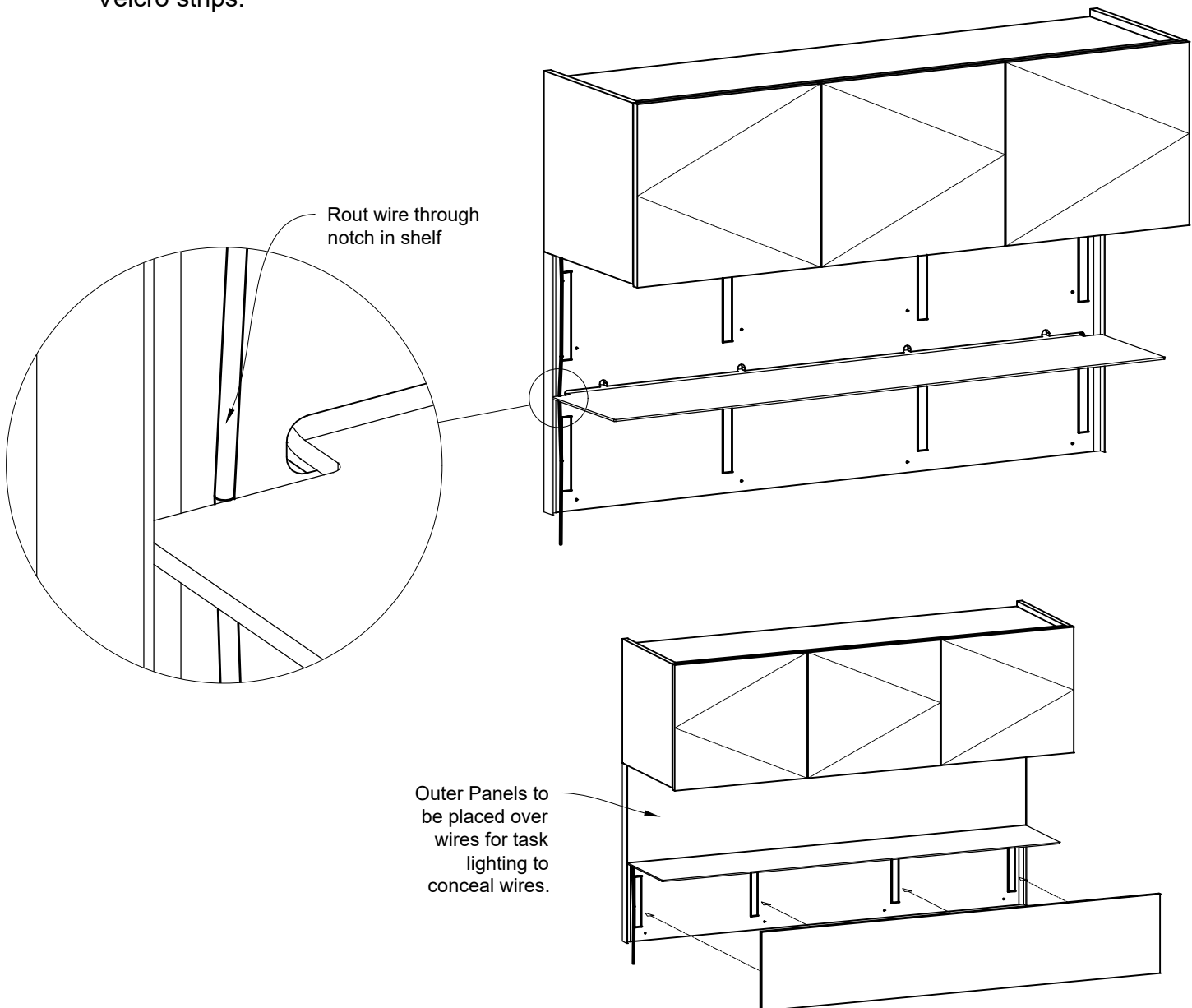

WALL HUTCHES

Open Shelving, Cabinet, and Sliding Door Hutches:

1. Attach Wall Cleat to the wall.
(Installer responsible for attachment hardware)
2. Hang hutch onto wall cleat and screw down through wall cleat using #9 x 1-3/4" Flat Head Screws.

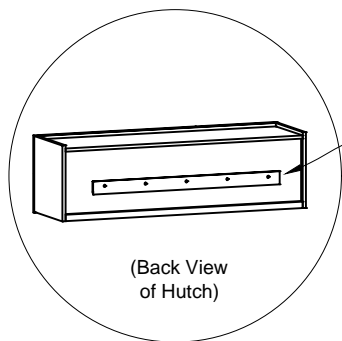

Cleats

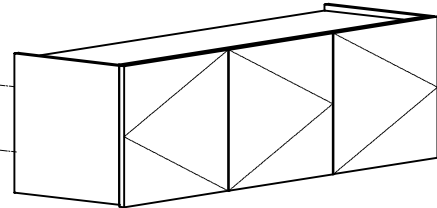
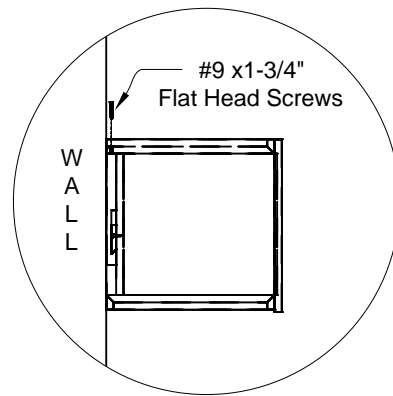

L-Sliding Door Hutches:

1. Attach Wall Cleat to the wall.
(Installer responsible for attachment hardware)
2. Hang hutch onto wall cleat
(Does not get screwed down through wall cleats)

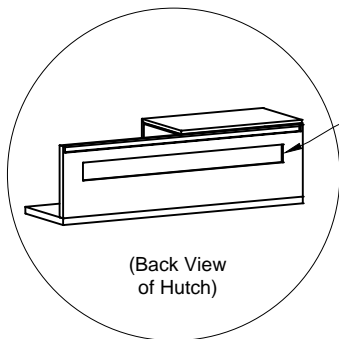

Cleats

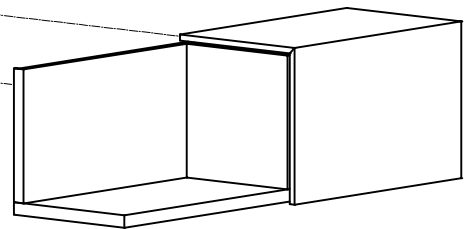

PEDESTALS

Pedestal to Top Connection:

1. Remove all drawers and adjustable shelving from pedestal. See page 18.
2. Align pedestal with credenza top.
3. Fasten the pedestal to the credenza top using #9 x 1-1/2" Flat Head Screws.
4. Replace drawers and shelving.

Brush Grommet Detail:

1. Install brush grommet to top prior to installing any items below credenza such as L-panels, T-legs, or pedestals.
2. Put brush grommet into place and attach using #9 x 5/8" Pan Head Screws.

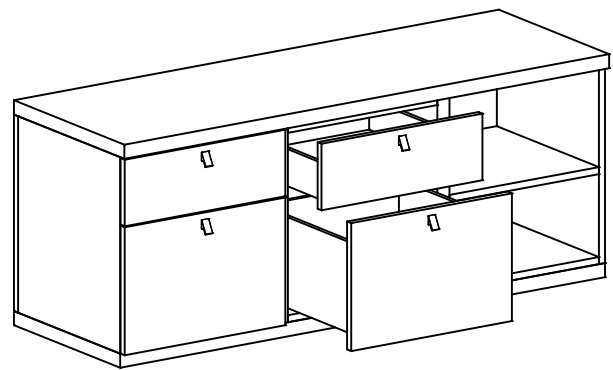
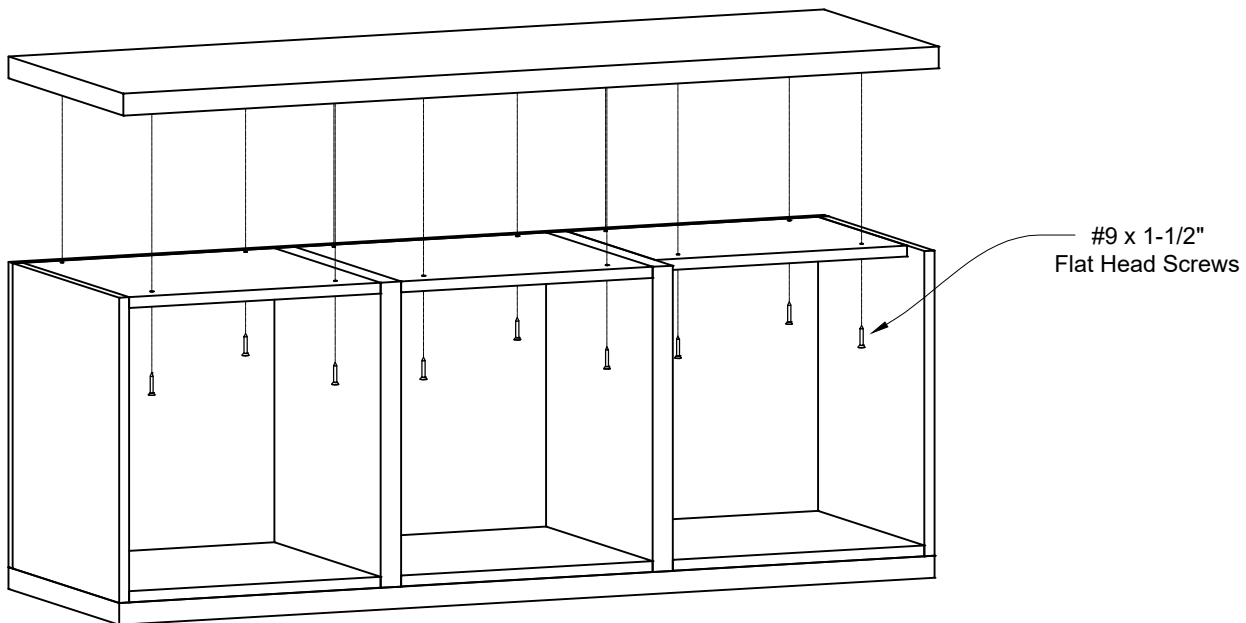
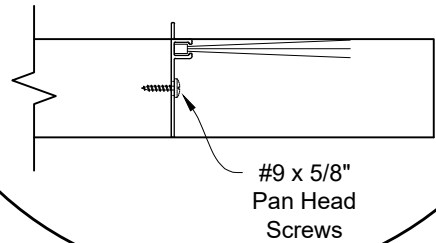

L-PANEL & T-LEG SUPPORTS

** Install brush grommet to top prior to installing L-Panels or T-Legs (See detail on page 4)

1. Attach panels together using mini fix cams.
2. Attach angle replacements to L-panel or T-Panel using 1/4-20 x 1/2" Flat Head Screws.
3. Attach L-panel or T-panel to the credenza top using #10 x 3/4" Flat Head Screws or #14 x 1" Flat Head Screws depending on top thickness.

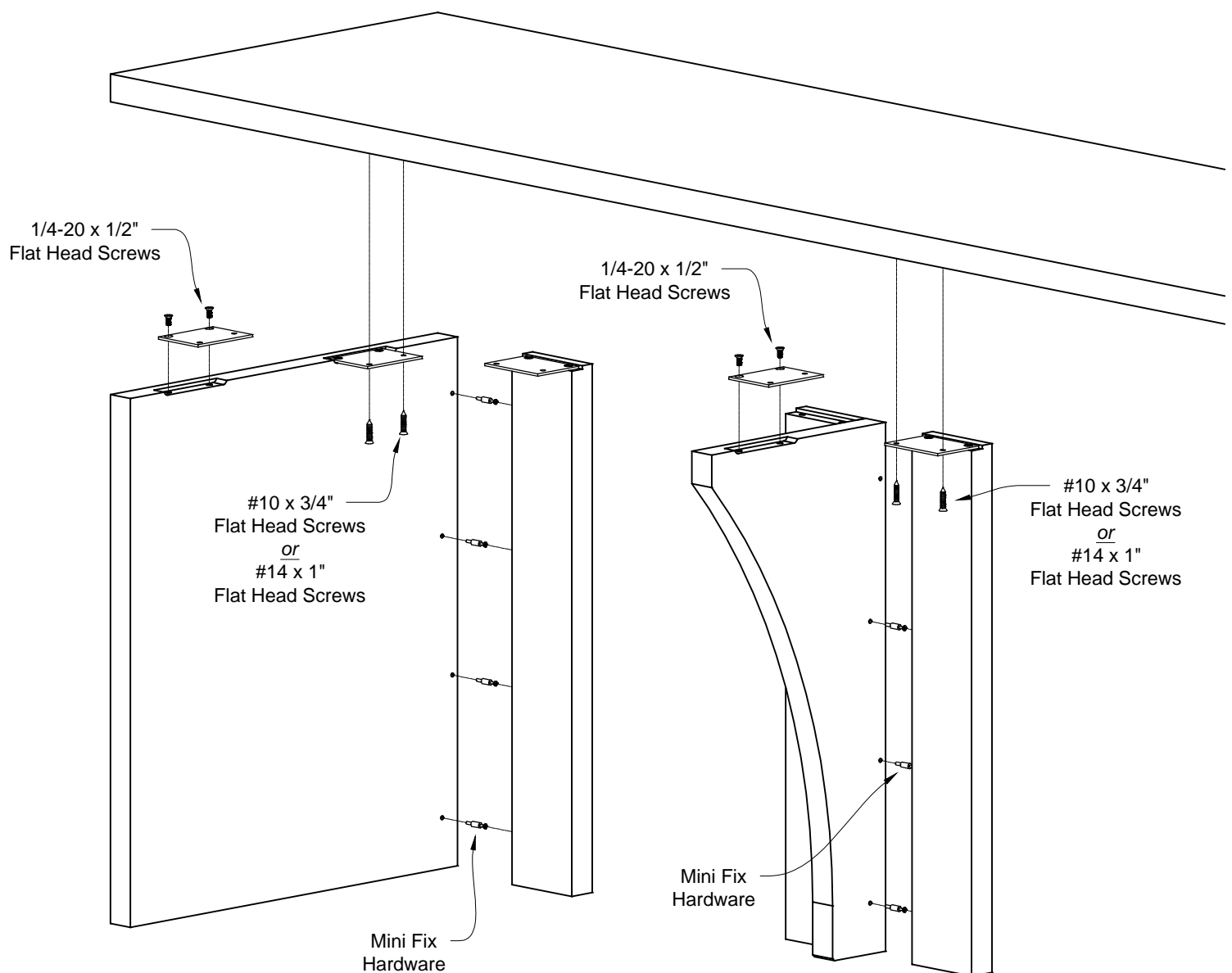

MODESTY PANELS - REMOVABLE

Modesty Panel Mounting Block Attachment Details

** Location of mounting block will be dependent on situation it is used in.

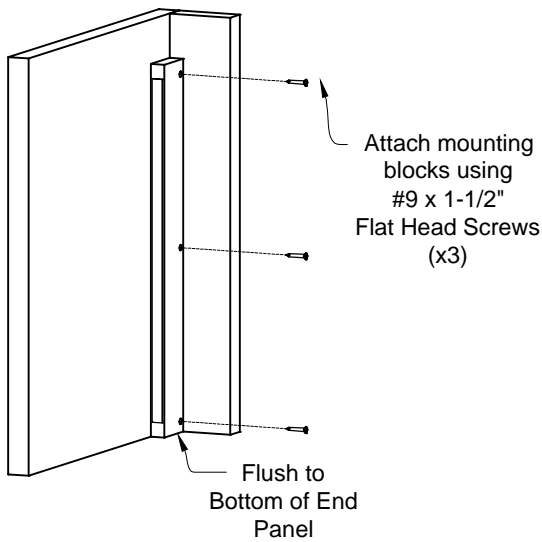

Mounting Block to L-Panel

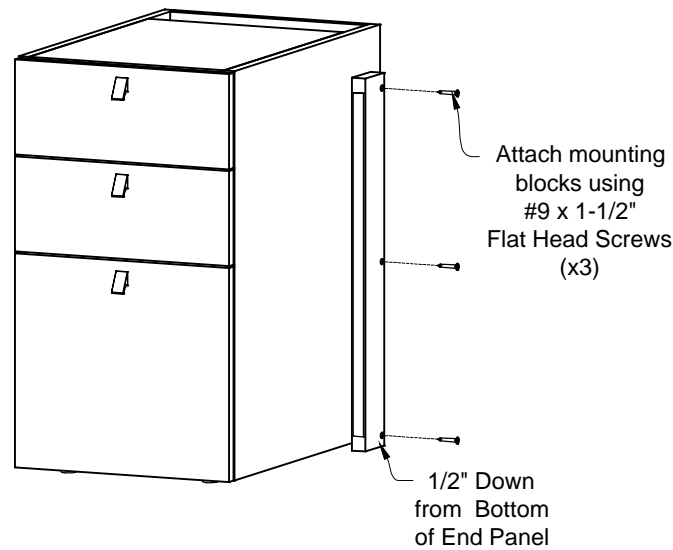

Mounting Block to Pedestal

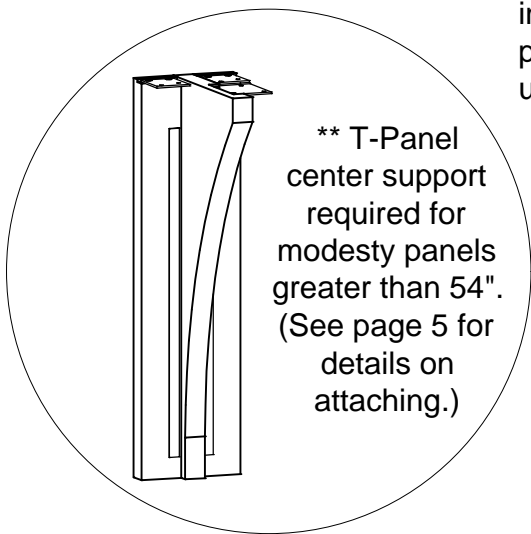

With mounting blocks installed, fasten modesty panel to mounting blocks using pre-installed velcro.

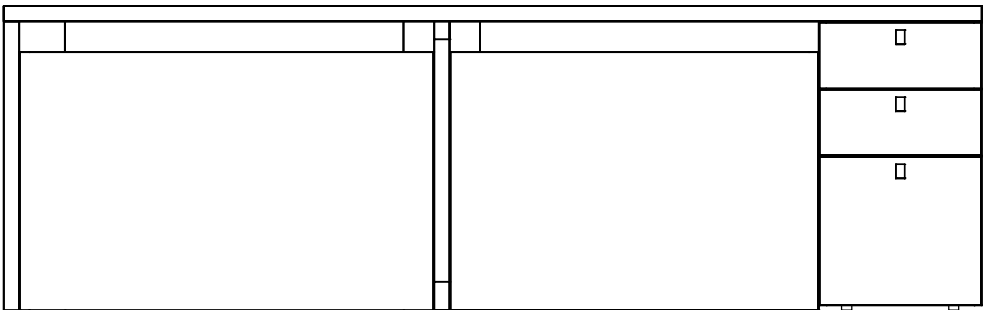
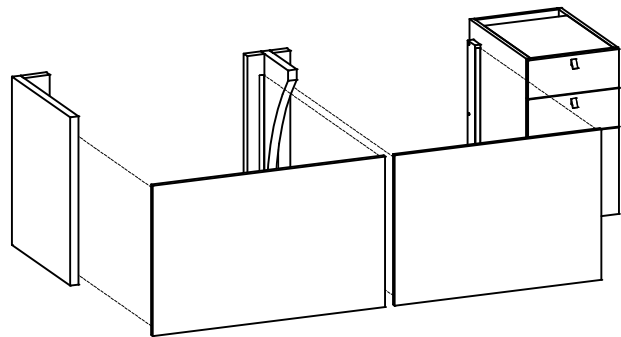

MODESTY PANELS - HORIZONTAL HINGE

Modesty Panel Mounting Block Attachment Details

** Location of mounting block will be dependent on situation it is used in.

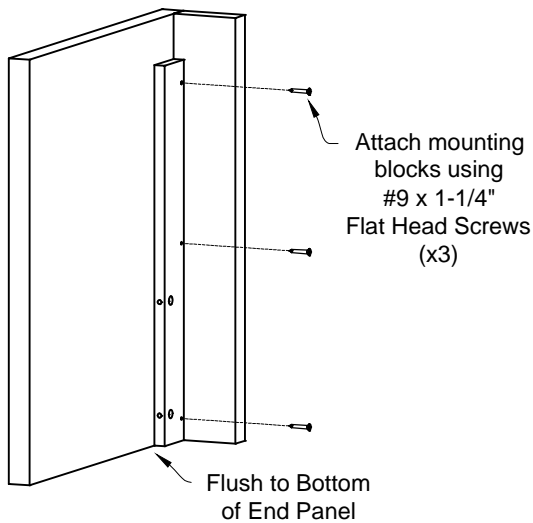

Mounting Block to L-Panel

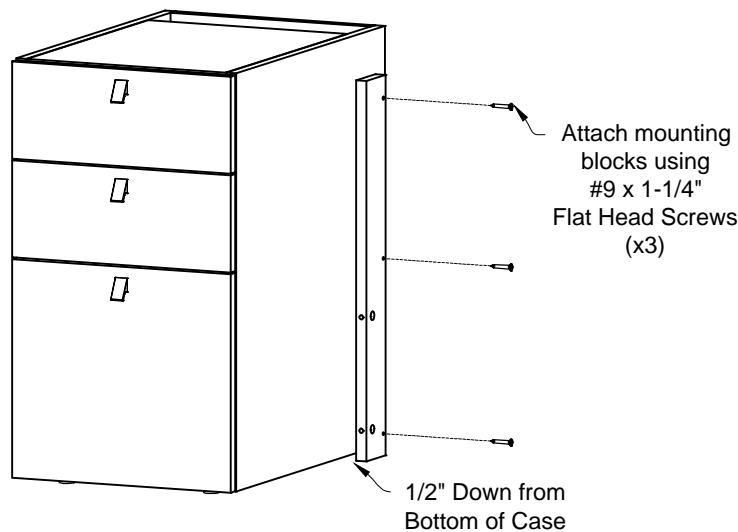

Mounting Block to Pedestal

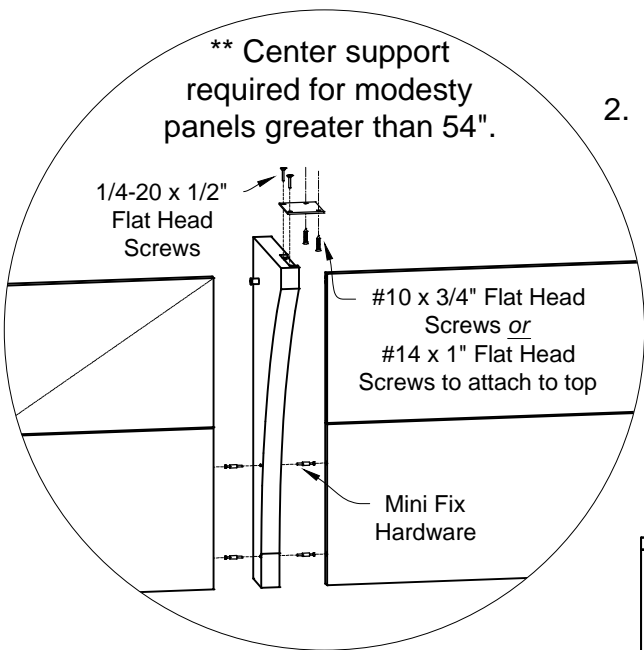

1. Attach Uni-Connect Hardware to mounting blocks, center support and modesty panels.
2. Attach modesty assembly to mounting blocks with Mini Fix Hardware.

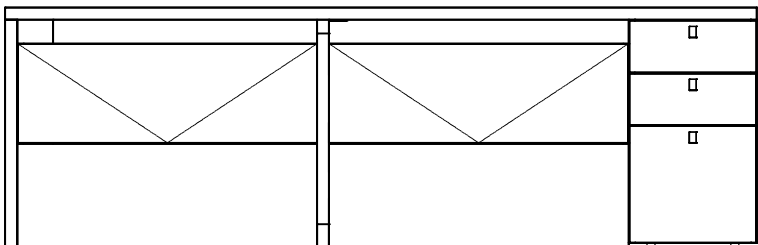
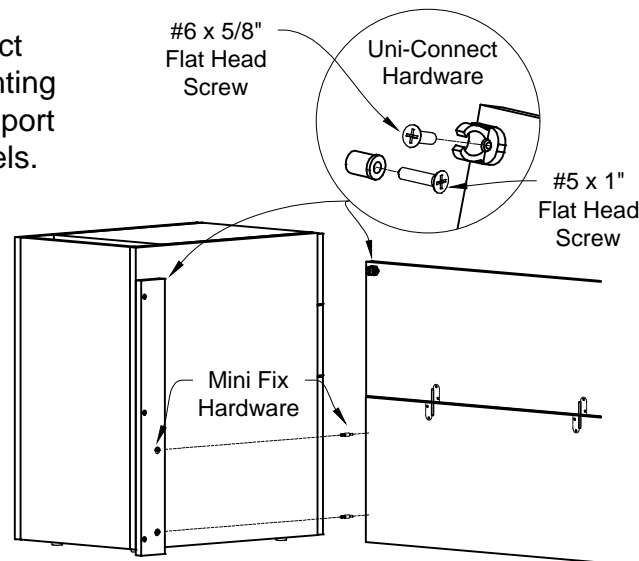

MODESTY PANELS - VERTICAL HINGE

Modesty Panel Mounting Block Frame Attachment Details

** Location of mounting block frame will be dependent on situation it is used in.

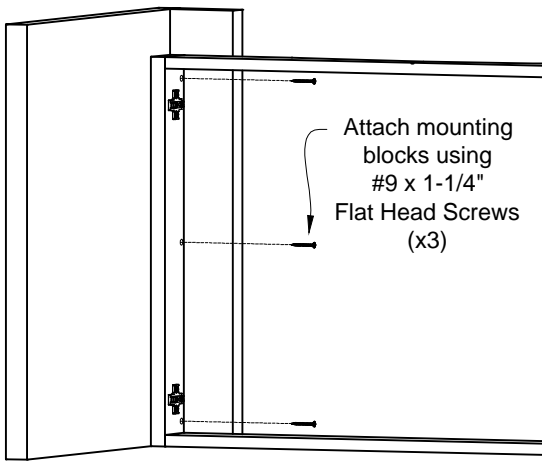

Mounting Block to L-Panel

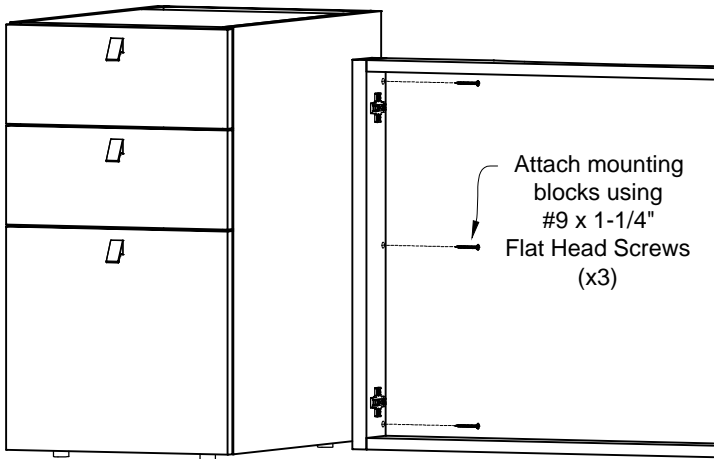

Mounting Block to Pedestal

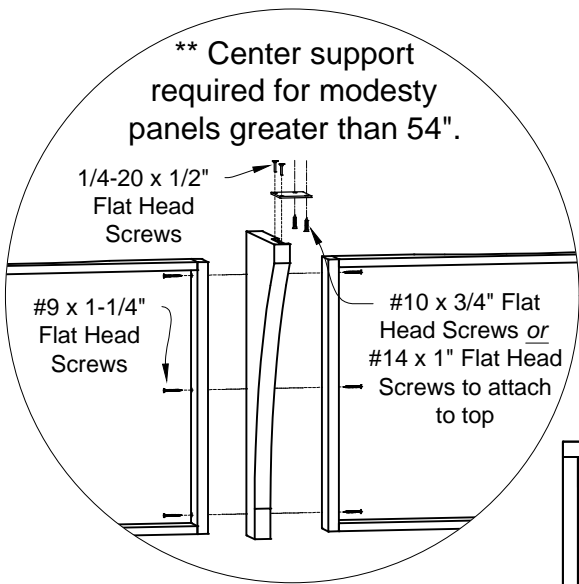

** Doors will come installed on the frame. Remove doors if necessary to install frame, and reinstall after the frame is installed.

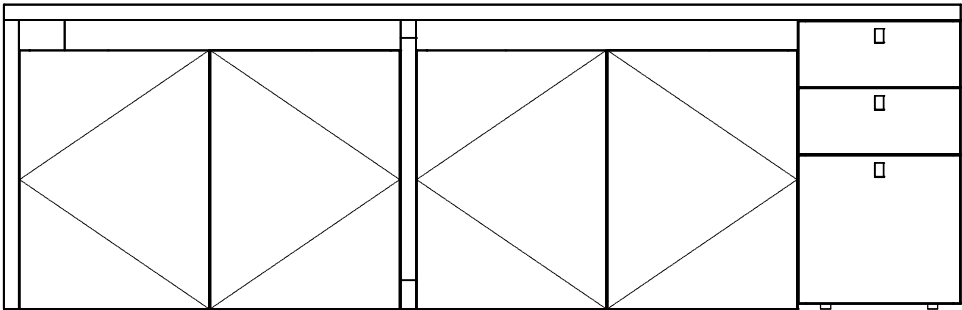
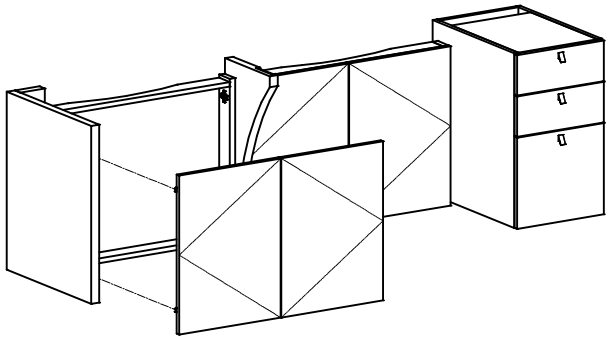

CORNER SHELVING TOWER

** Attach Corner Shelving Towers to wall

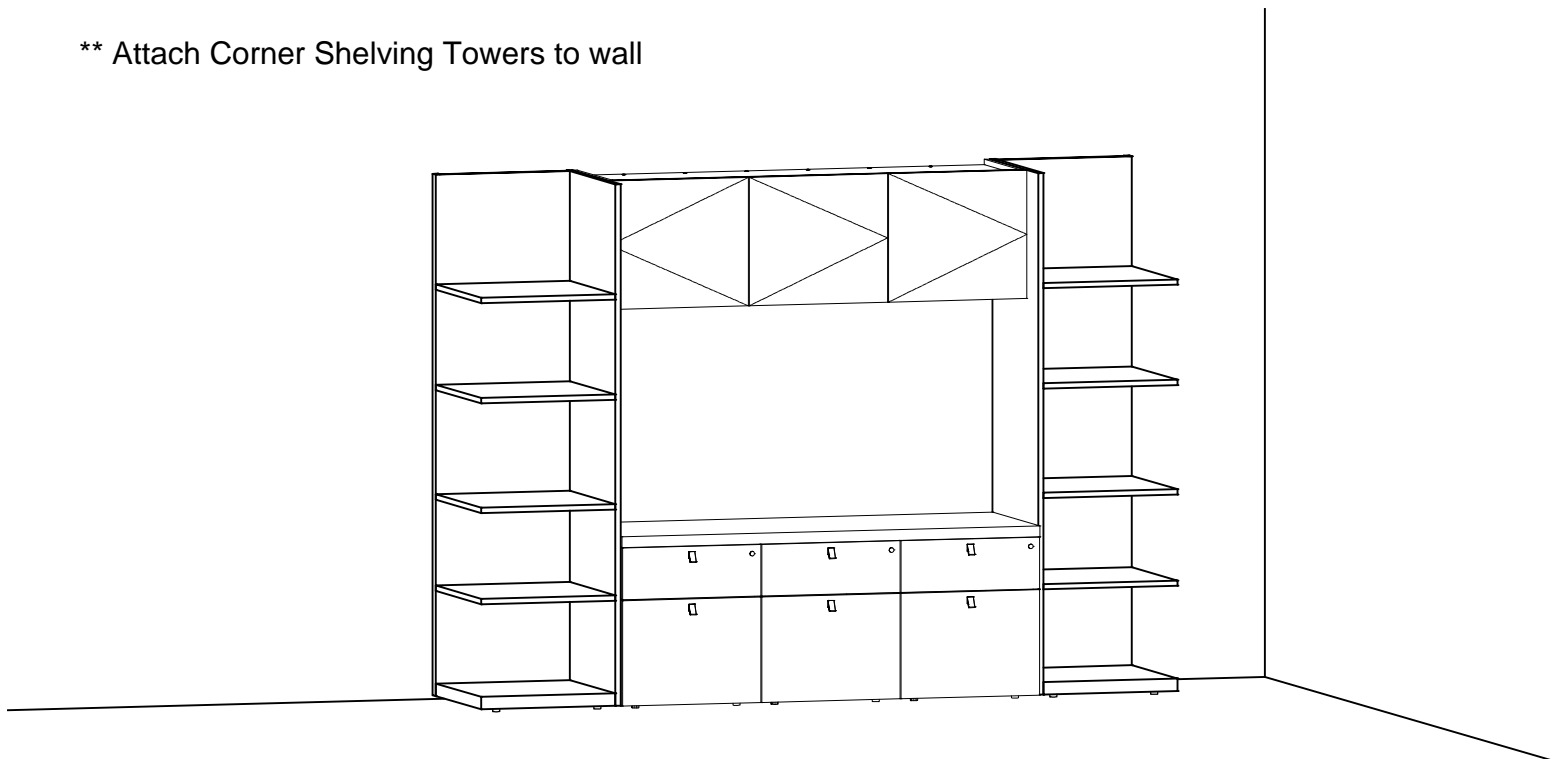

1. Attach wall cleat to wall
(Installer responsible for attachment hardware)
2. Hang tower on the wall cleat.
3. Drop levelers to floor.

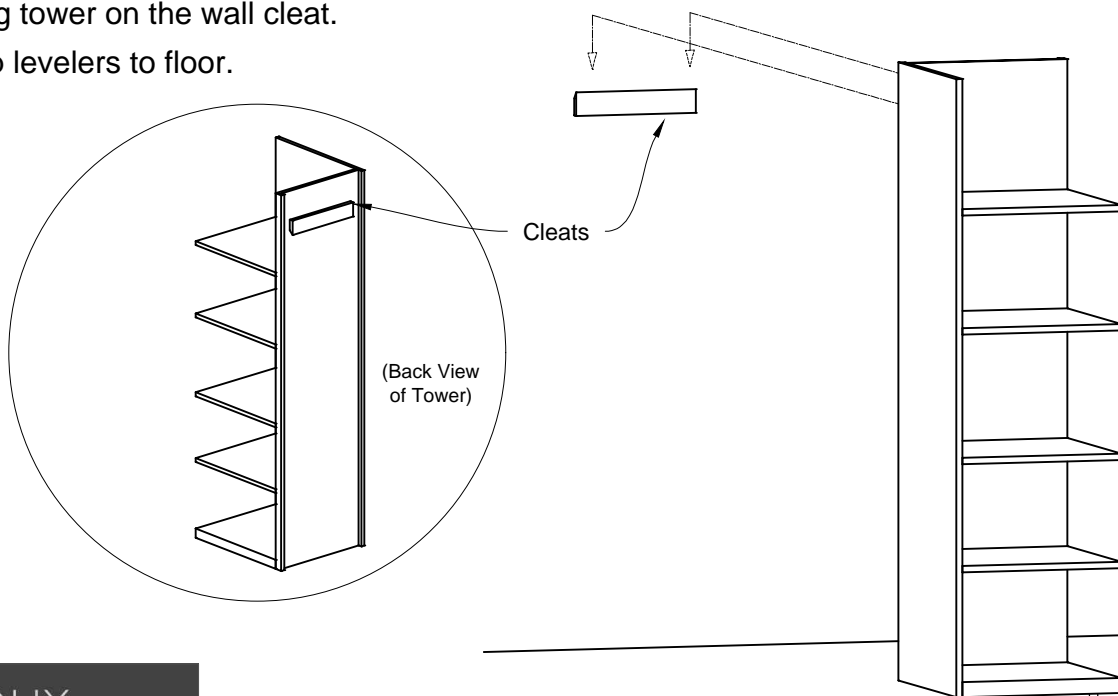

DIVIDER PANELS

1. Align pre-installed 1/4-20 inserts in bottom of divider panel with corresponding attachment holes of work surface.
** Temporarily placement of lower support units may be required to access connection holes from under-side of work surface to install divider panel.
2. With divider panel closely situated in place, fasten securely with 1/4-20 x 2" Pan Head Screws and 5/16" Flat Washers thru work surface into receiving inserts in bottom edge of divider.
- ** Secure at each connection hole. Quantity is dependent on size of divider panel.

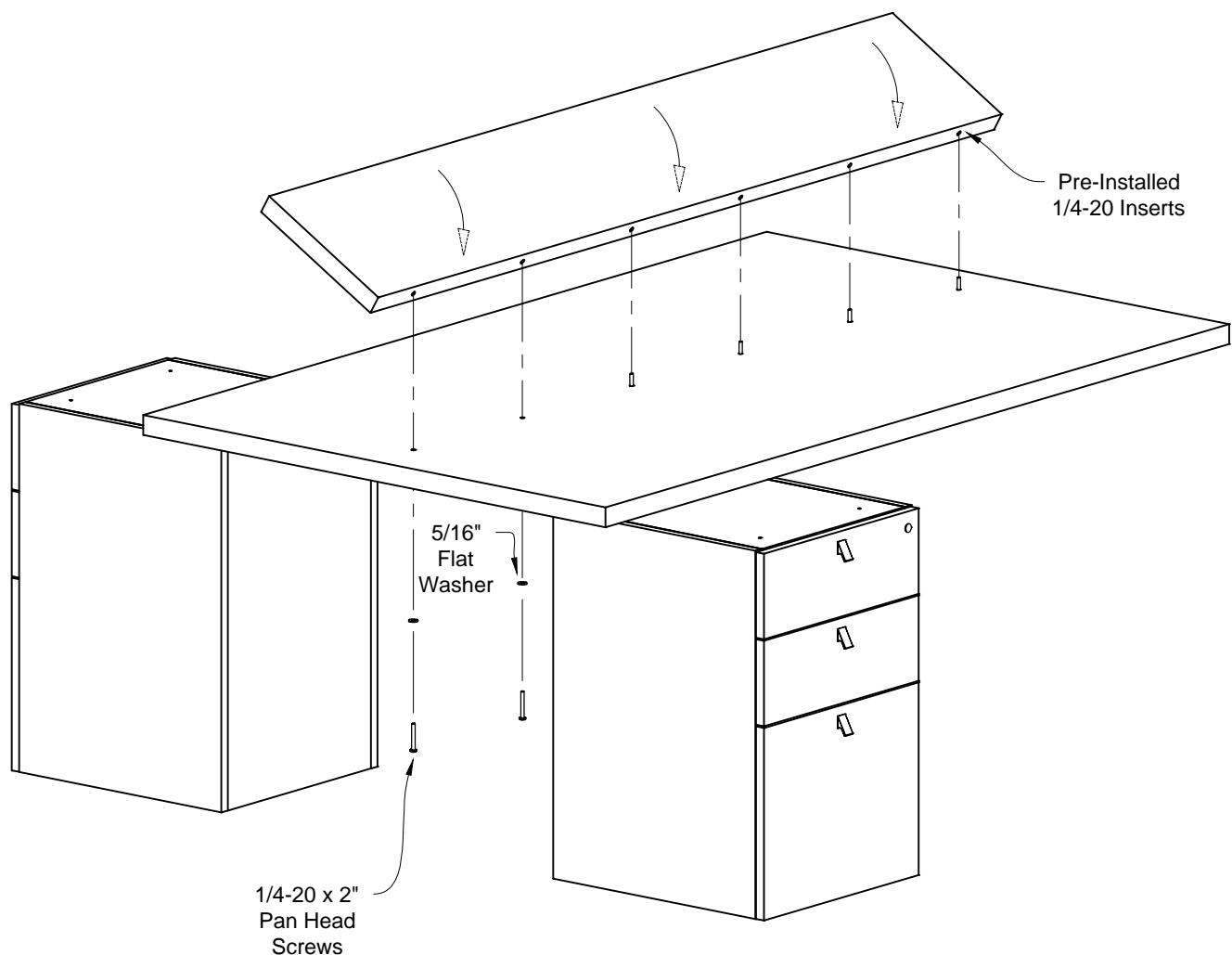

FIXED HEIGHT DESKS

Assembling Fixed Height Desks:

1. Attach modesty panel to end panels using pre-installed mod clips and #12 x 5/8" Shoulder Screws.
 2. Attach top using Flat Plate Support Brackets and #10 x 3/4" or #14 x 1" Flat Head Screws.
- ** Match pocket milling to respective Flat Plate Support Brackets.

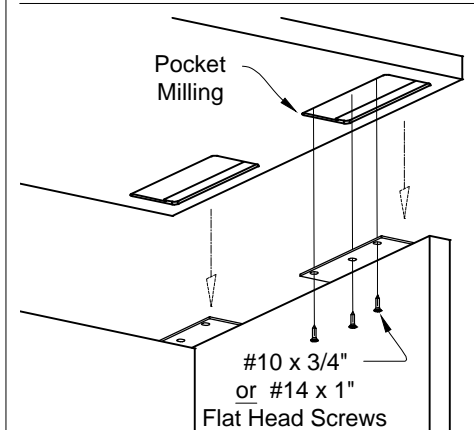
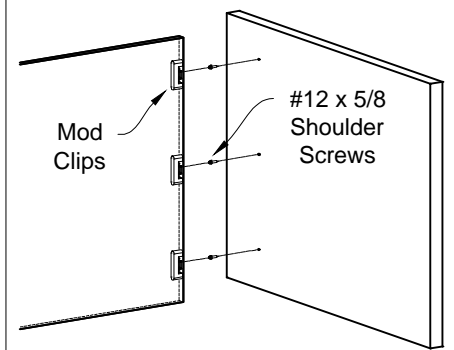
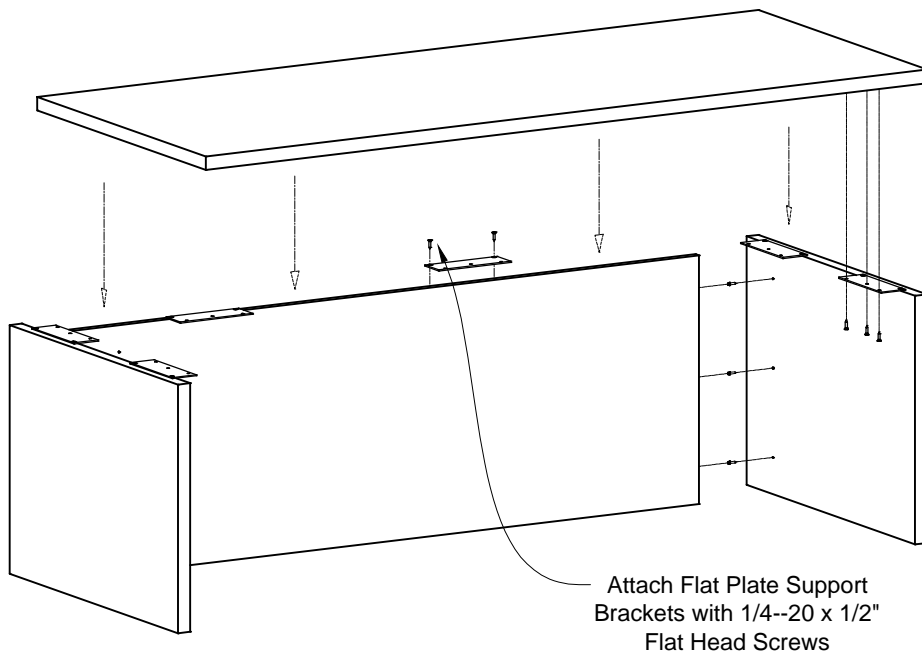

Typical Pedestal Connection

1. Place pedestal into position and make sure it is level.
2. Attach pedestals by securing to end panel & modesty panel using #9 x 1-1/4" Flat Head Screws.
3. Attach pedestal to work surface with #9 x 1-1/2" Flat Head Screws.

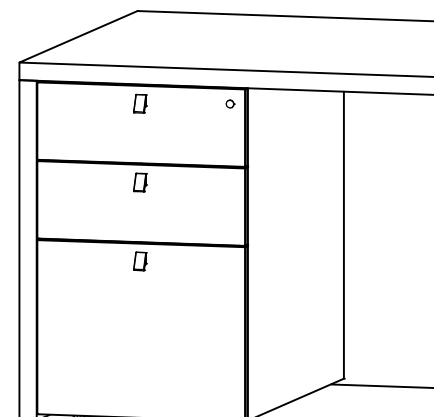
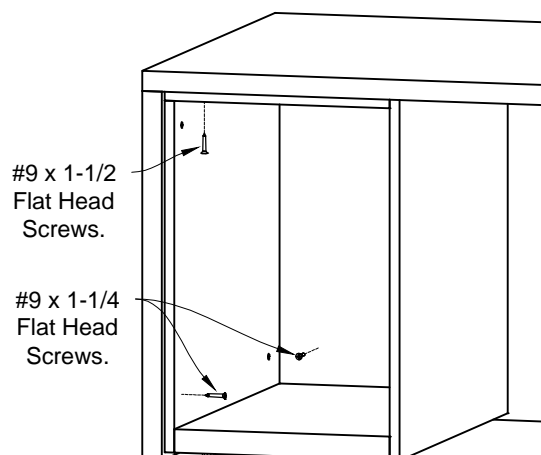

FIXED HEIGHT RUNOFF SHELLS

Assembling Fixed Height Runoffs:

1. Attach modesty panel to end panel using pre-installed mod clips and #12 x 5/8" Shoulder Screws.
2. Attach filler panel to modesty panel using 50mm Confirmat Screws.
3. Attach top using Flat Plate Support Brackets and #10 x 3/4" or #14 x 1" Flat Head Screws.
** Match pocket milling to respective Flat Plate Support Brackets.
4. See Page 11 for Typical Pedestal Connection.

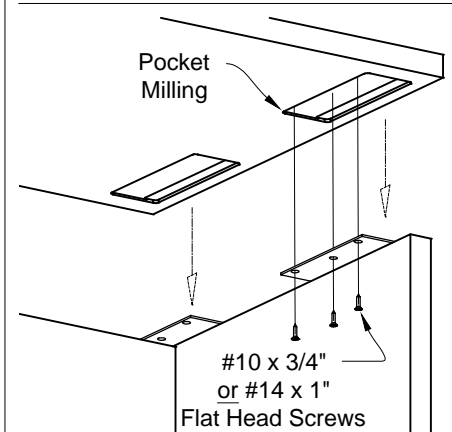
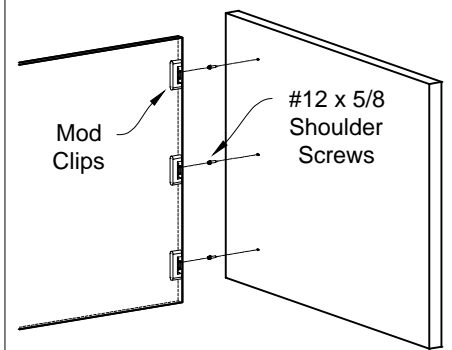
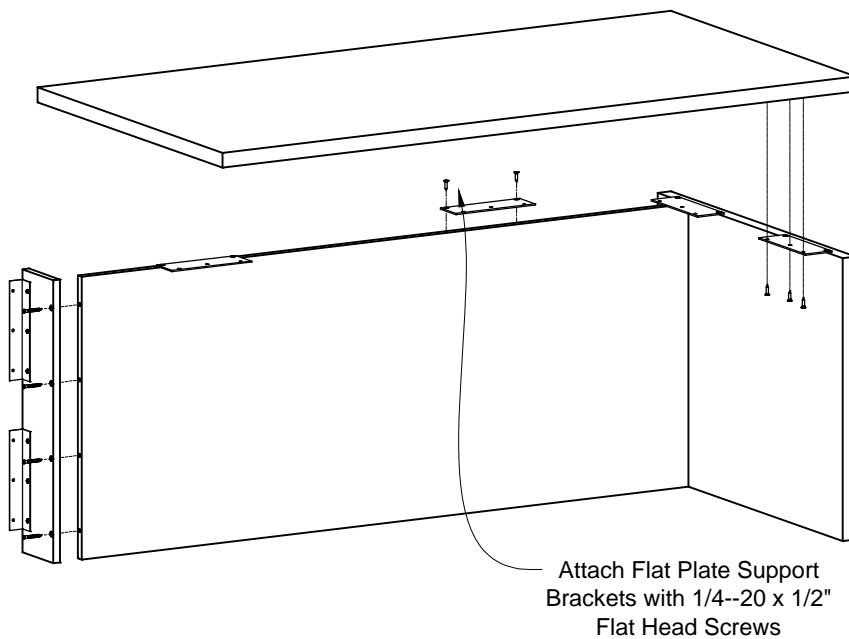

Connect Runoff to Adjacent Credenza or Desk:

1. Connect 10" Angle Irons on the filler to the adjacent unit.
2. Secure tops together using bridge plates and #16 x 1" Pan Head Screws.

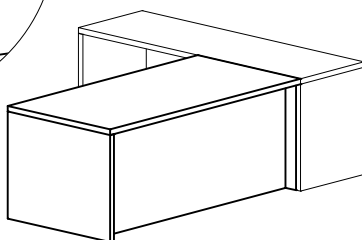
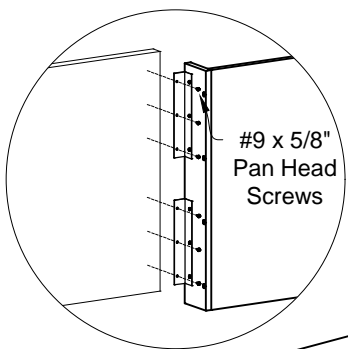

Bridge Plate
(Style and
Qty of Plates
May Vary)

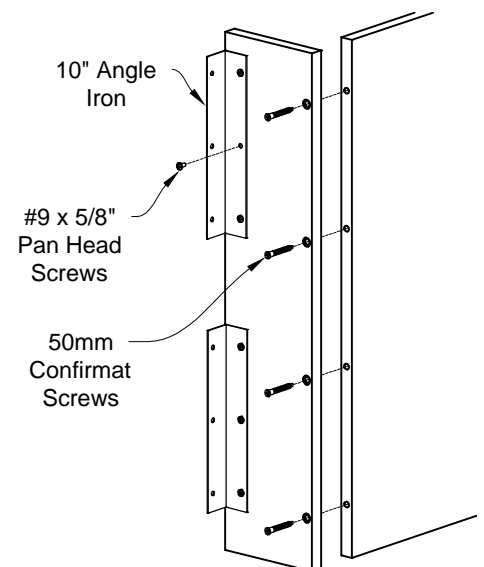
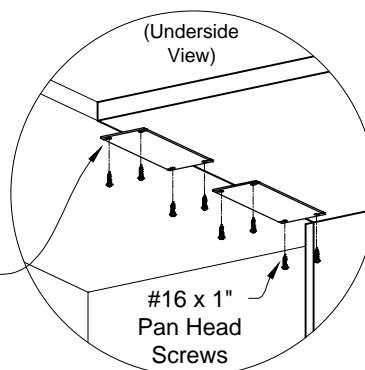

FIXED HEIGHT RUNOFFS WITH LEGS

Leg Connections

Straight Leg Attachment:

Attach each leg in pre-drilled holes using #10 x 1-1/2" Flat Head Screws.

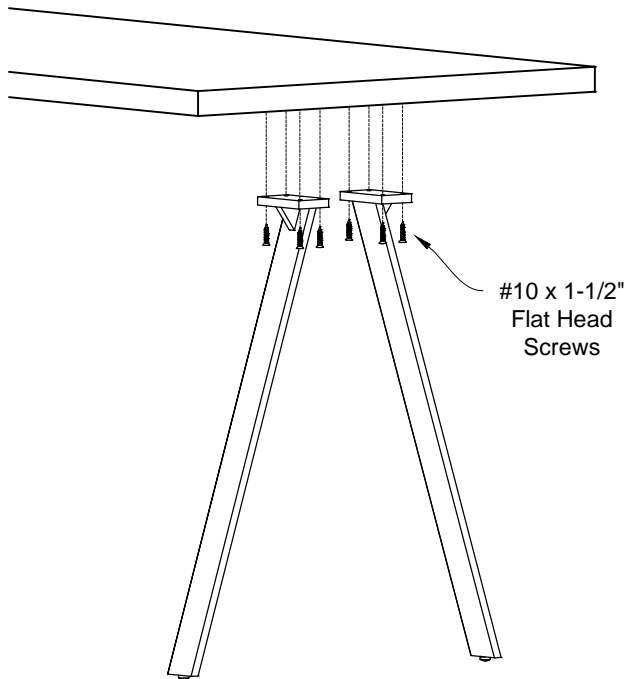

Loop Leg Attachment:

Attach leg in pre-drilled holes using #10 x 1-1/2" Flat Head Screws.

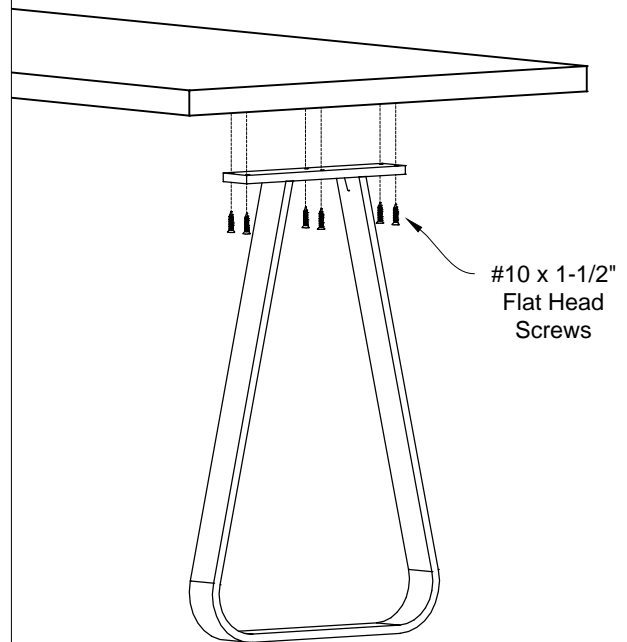

Runoff to Credenza Connection

1. Align bridge plates to underside of runoff and credenza so the bridge plate is centered evenly on the seam between the two tops.
2. Screw bridge plates into tops to secure the tops together using #16 x 1" Pan Head Screws.

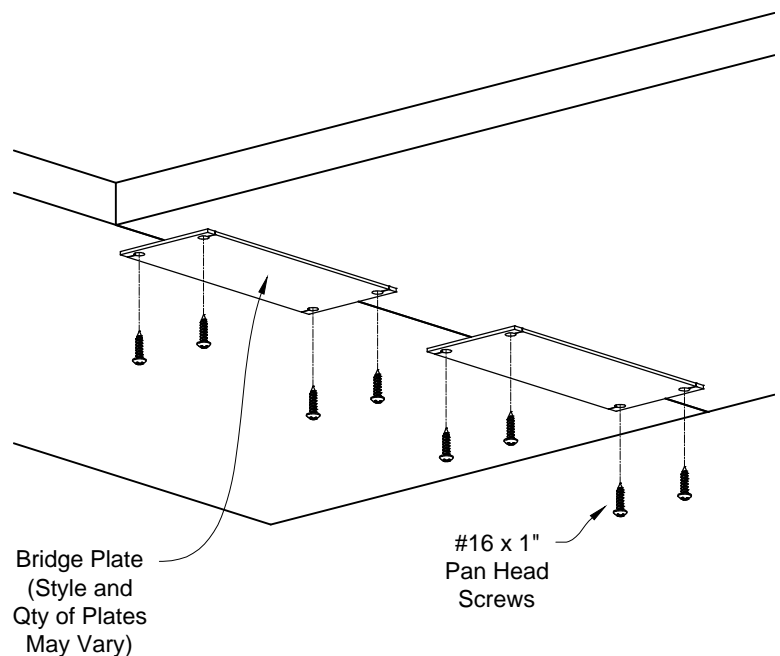

ADJUSTABLE HEIGHT - DESKS

Assembling Adjustable Height Desks:

1. Attach modesty panel to end panels using pre-installed mod clips and #12 x 5/8" Shoulder Screws.
2. Attach desk plinths or pedestals into place (See Typical Attachments).

Typical Plinth Attachment:

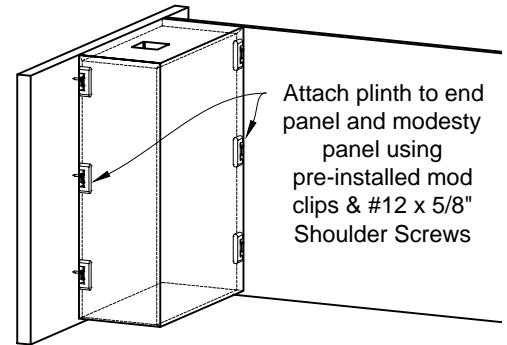
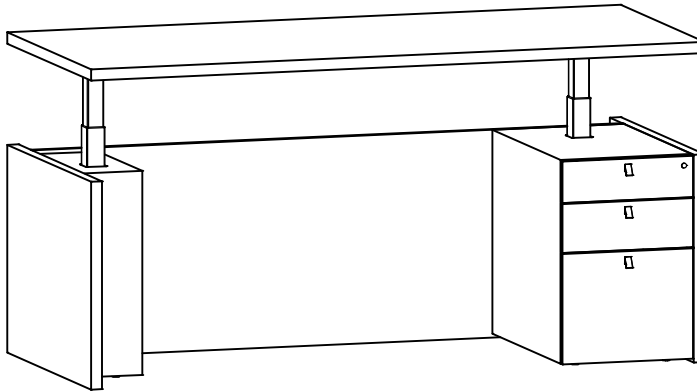

Attach plinth to end panel and modesty panel using pre-installed mod clips & #12 x 5/8" Shoulder Screws

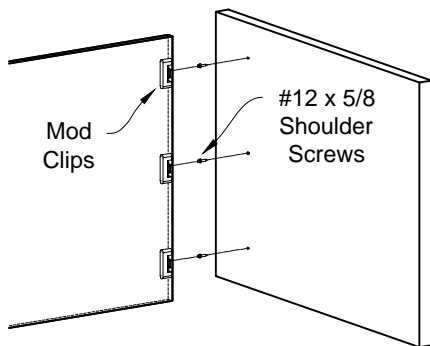

Mod Clips

#12 x 5/8
Shoulder
Screws

Typical Pedestal Attachment:

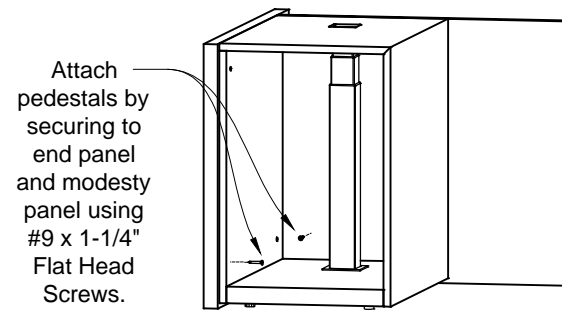

Attach pedestals by securing to end panel and modesty panel using #9 x 1-1/4" Flat Head Screws.

Top Attachment:

1. Temporarily connect electrical cords for legs and keypad to control box. Plug control box into outlet and raise legs out of credenza.
2. Install mounting plate to leg using M8 1.25 x 18mm Flat Socket Cap Screws.
3. Screw top to mounting plates using #10 x 1" Pan Head Screws.
4. Mount optional dimmer controller into hole on underside of table. (See page 17 for details)

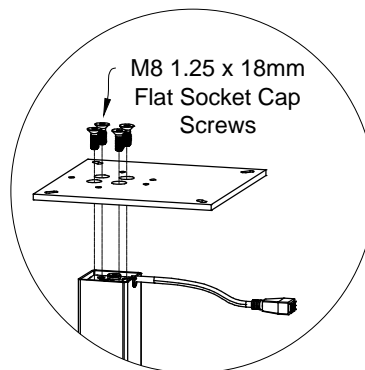

M8 1.25 x 18mm
Flat Socket Cap
Screws

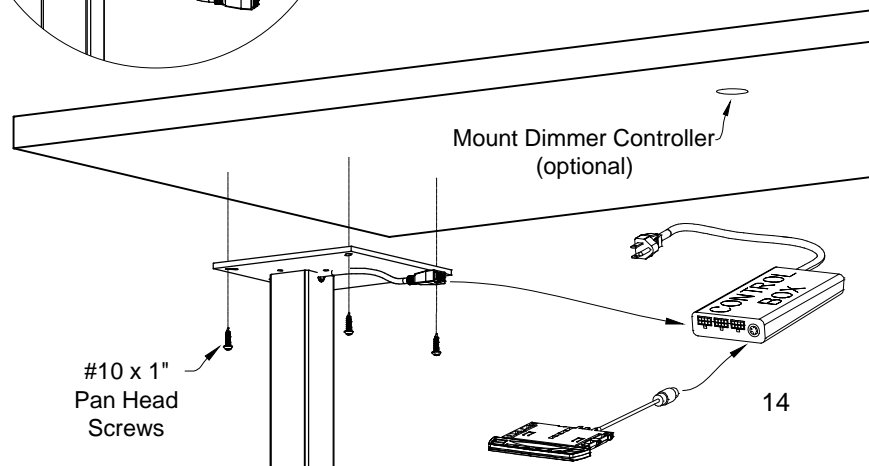

Mount Dimmer Controller (optional)

#10 x 1"
Pan Head
Screws

ADJUSTABLE HEIGHT - RUNOFFS

Assembling Adjustable Height Runoffs:

1. Attach modesty panel to end panel using pre-installed mod clips and #12 x 5/8" Shoulder Screws.
2. Attach desk plinths or pedestals into place.
(See Typical Attachments on page 14)
3. Attach runoff plinth to modesty panel using 50mm Confirmat Screws.
4. Connect 10" Angle Irons on the runoff plinth to the adjacent unit.

Runoff Plinth Attachment:

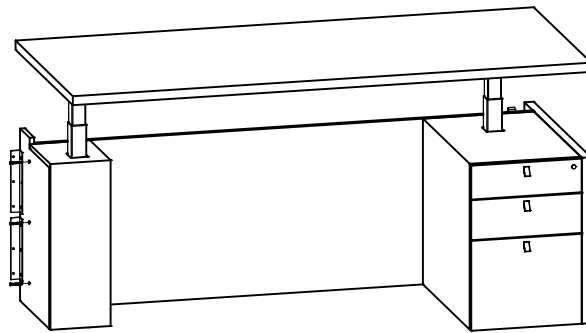
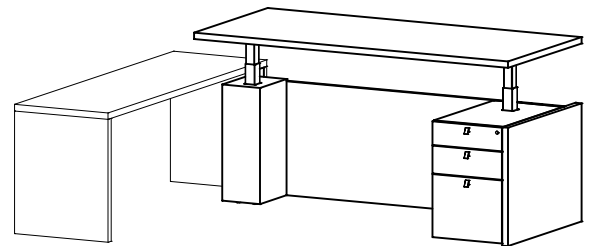
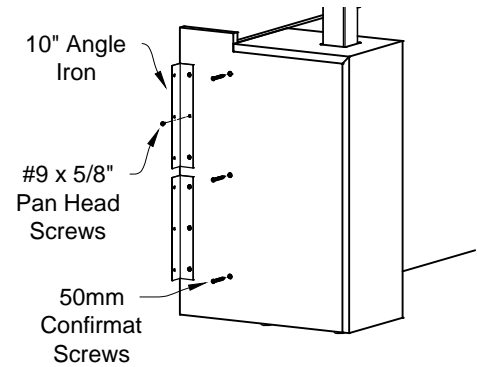
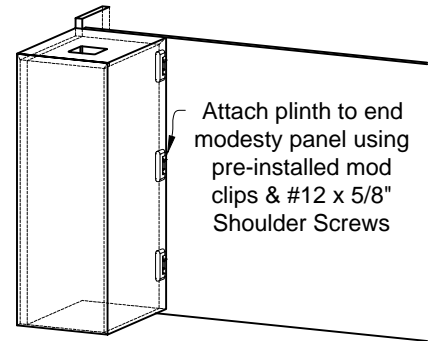

Top Attachment:

1. Temporarily connect electrical cords for legs and keypad to control box. Plug control box into outlet and raise legs out of credenza.
2. Install mounting plate to leg using M8 1.25 x 18mm Flat Socket Cap Screws.
3. Screw top to mounting plates using #10 x 1" Pan Head Screws.
4. Mount optional dimmer controller into hole on underside of table. (See page 17 for details)

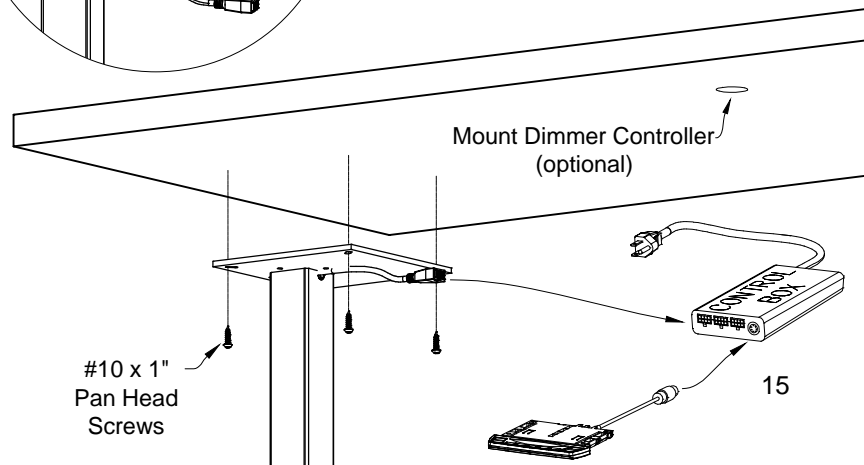
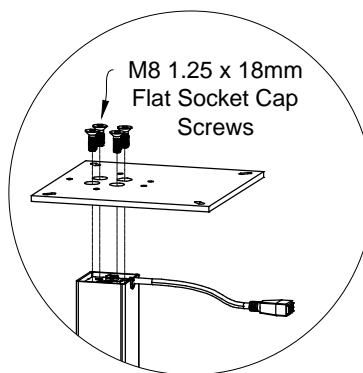

ADJUSTABLE HEIGHT - WALL HUNG CREDENZA

Securing Wall Hung Credenza to Wall:

1. Attach wall cleat to wall
(Installer responsible for attachment hardware)
2. Hang wall hung credenza on the wall cleat.

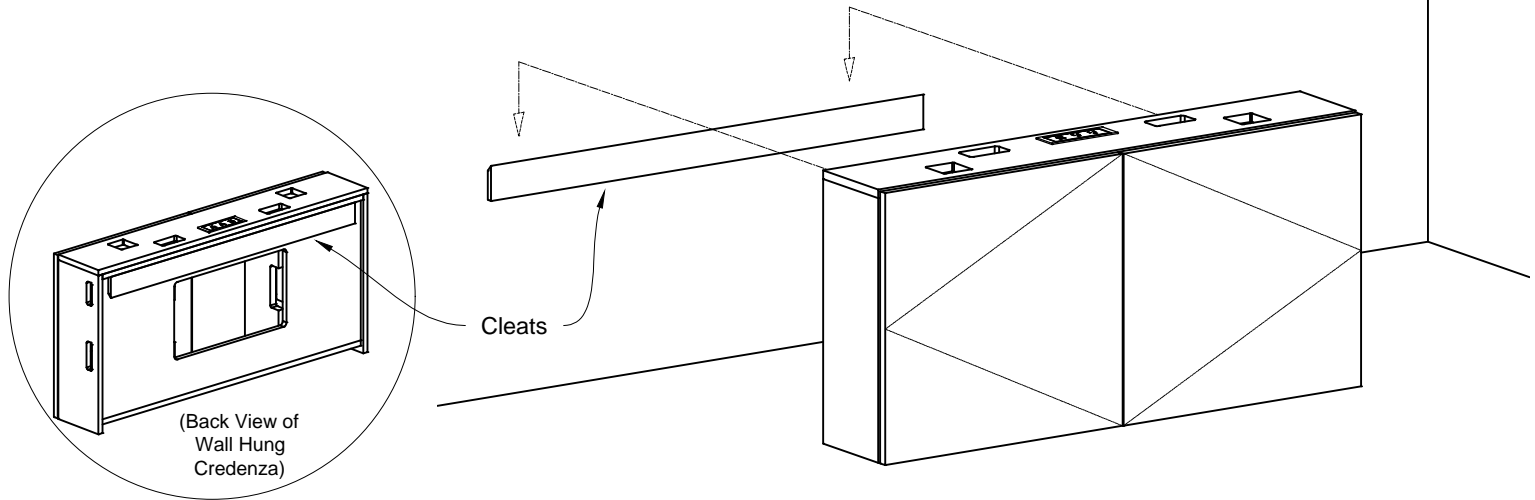

Top Attachment:

**** Secure Wall Hung Units to Wall Prior to Attaching the Top.**

1. Temporarily connect electrical cords for legs and keypad to control box. Plug control box into outlet and raise legs out of credenza.
2. Install mounting plate to leg using M8 1.25 x 18mm Flat Socket Cap Screws.
3. Screw top to mounting plates using #10 x 1" Pan Head Screws.
4. Mount optional dimmer controller into hole on underside of table. (See page 17 for details)

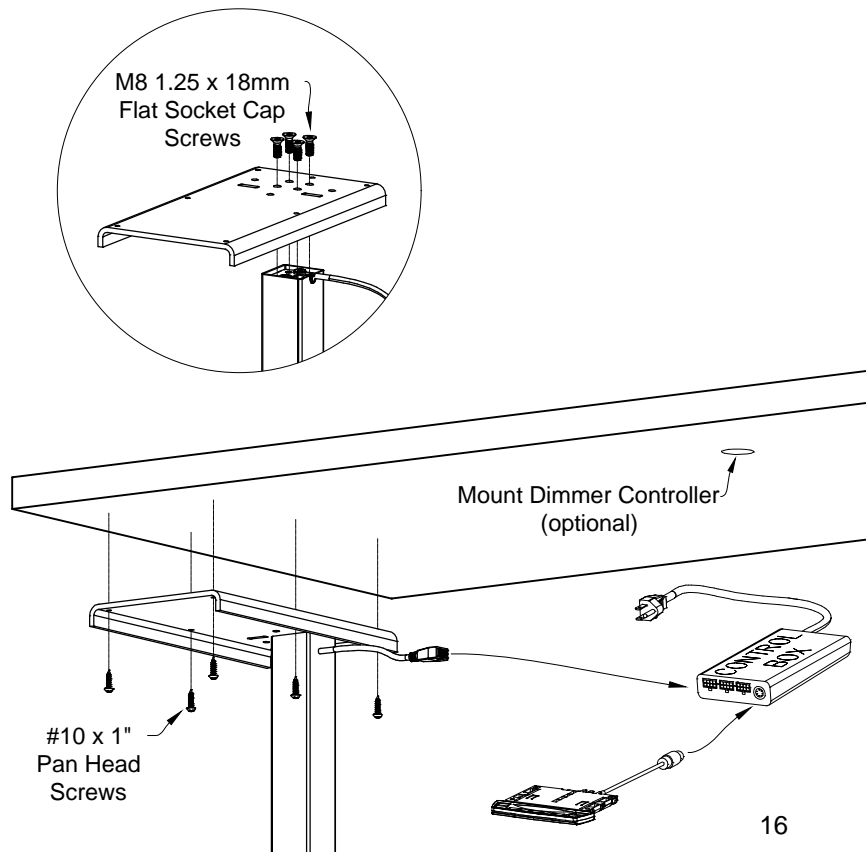

Remote Specifications:

P/N: L-WLDIM-1RND

Operating Voltage: 3V CR2025 battery

Working Frequency: 916.5 MHz

RF Remote Distance: 15m (50 ft.)

Receiver Specifications:

P/N: L-WLDIM-1REC

Input Voltage: 12V DC

Output Voltage: 12V DC

Max-Output Load: 5A, 60W

Dimming Range: 100% - 5%

Installation Instructions

Single Zone Wireless Round Dimmer

12V DC 60W Capacity

READ ALL INSTRUCTIONS BEFORE INSTALLING SYSTEM.

Before beginning installation, be sure power is turned OFF to light system.

Programming Instructions:

1. Disconnect mounting block from 12V DC Tresco power supply (see spec guide for power supply options). Connect dimmer receiver to Tresco 12V DC power supply by locating the input wire to the receiver and snapping the male AMP connector to female AMP connector located on output wire of the power supply (Figure 2).

**To use multiple receivers on one power supply, connect the input wire of the mounting block to the power supply output and then plug the receivers into the mounting block.*

2. Take the mounting case off of the round dimmer controller (Figure 1). Remove the clear plastic tab to activate the battery.

3. Plug desired light(s) into the mounting block.

4. Plug polarized 2-prong end of Tresco 12V DC power supply wire into 120V receptacle. If receptacle is operated by on/off wall switch, turn switch on after plugging power supply in.

5. Press (do not hold down) the learning key (Figure 3) on the dimmer receiver once, then press (do not hold down) the power button on the round dimmer controller once. The lights should flash on/off, indicating they are programmed properly.

6. Repeat step 5 with any additional receivers or controllers that you want programmed.

**Each receiver can be controlled by up to 8 different controllers. A single controller can control up to 10 receivers.*

How to Deprogram a Receiver:

1. Hold down the Learning Key on the dimmer receiver until the lights connected to the receiver flash on/off twice.

2. The receiver is now reset and is no longer programmed to any controllers.

Dimmer Mounting Instructions:

1. There are four options for mounting: screws (Figure 4), magnet (located on bottom of casing), recessed, or double-stick adhesive (included in package).

2. To mount with screws, first remove the recess spring from the casing and the dimmer from the casing. Position the casing at desired location, being sure to align the "notch" on the inner wall of the casing (Figure 5) at the top of the cylinder to ensure proper orientation of the control button on the dimmer.

3. Mark screw hole locations and use a 1/16" drill bit for pilot holes. Drive screws through holes in casing into pilot holes, again ensuring that the notch on the casing is at the top portion of the cylinder.

4. Slide dimmer control unit into dimmer casing (Figure 6).

5. To mount recessed, route hole 42 mm wide and a minimum of 13.5 mm deep. Push casing into routed hole with alignment notch pointing up and place dimmer control unit into casing (Figure 7).

IMPORTANT SAFETY INSTRUCTIONS**CAUTION: To reduce the risk of fire, electric shock, or injury to persons:**

- Route and secure cords so they will not be pinched or damaged when cabinet is pushed to the wall.
- Use only insulated staples or plastic ties to secure ALL loose cords.
- Replace battery with CR2025 Battery only. Not rechargeable.
- 12VDC input only to receiver
- 12VDC 60W 5AMP max receiver output
- Use only in dry locations. Not for use where exposed to the weather
- Not intended for recessed installation in ceilings or soffits
- A licensed electrician should be consulted for wiring through ceilings, soffits, or walls
- All wiring must follow NEC regulations.

SAVE THESE INSTRUCTIONS FOR FUTURE REFERENCE.

For technical assistance: 1-800-227-1171

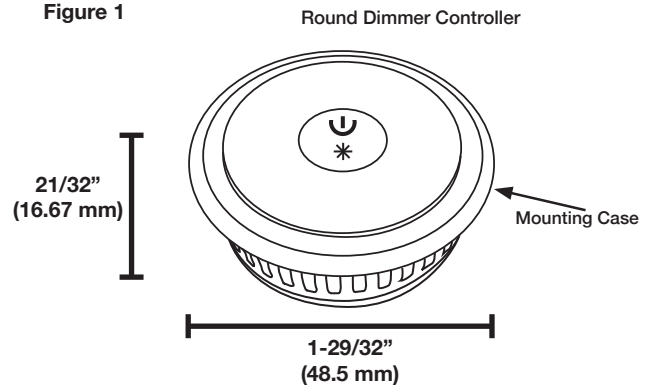
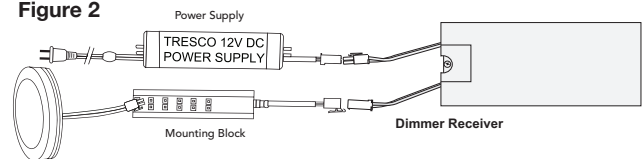
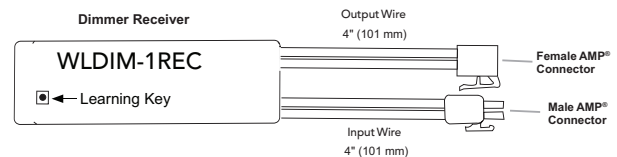
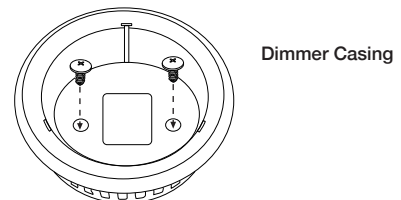
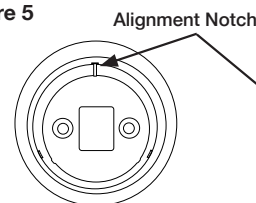
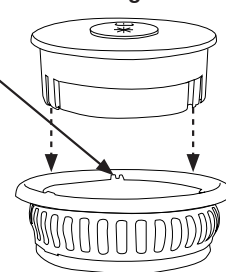
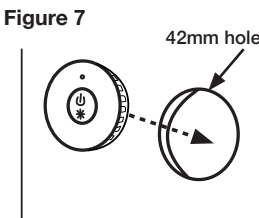
Figure 1**Figure 2****Figure 3****Figure 4****Figure 5****Figure 6****Figure 7**

tresco lighting
 cUL US CE FC

Tresco Lighting by Rev-A-Shelf

12400 Earl Jones Way

Louisville, KY 40299

Tel: 800-227-1171

Fax: 502-491-2215

Email: cservice@trescolighting.com

Web: www.trescolighting.com

I-WLDIM1RND-0819

FACE ADJUSTMENTS / DRAWER INSTALLATION / REMOVAL

Side-to-side adjustment

- 1 Rotate side-to-side adjustment left or right equally on both locking devices. Drawer front moves in the same direction as rotation.

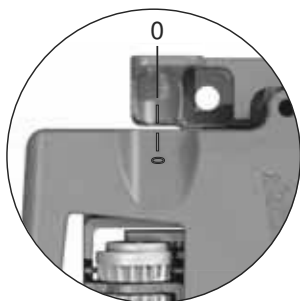
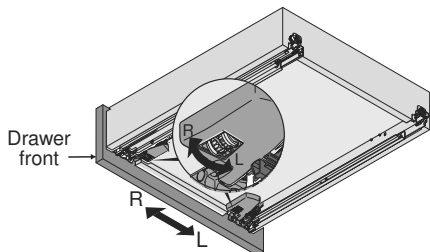

Rear side-to-side adjustment

- 2 After front side-to-side adjustment is made with the locking devices, rotate the rear side-to-side adjustment left or right to re-align the back of the drawer box with the front. Drawer back moves in the same direction as rotation.

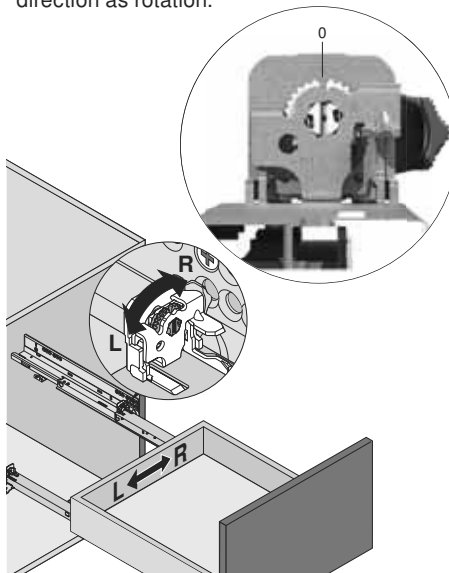

Maximum 1.5 (1/16") to left or right in both front and rear (tool-free)

NOTE: Side-to-side adjustment not available on T51.x8xx locking devices

Height adjustment

- 1 Press up on adjustment tab
- 2 Push towards back of drawer

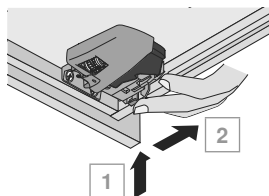

Maximum 3 (1/8") rise of drawer front (tool-free)

Maximum 5 (3/16") rise of drawer back (tool-free)

NOTE: Height and tilt adjustments available with all combinations of locking devices and runners

Tilt adjustment

Rotate the tilt adjustment lever on the rear of each runner to lift the back of the drawer and tilt the top of the drawer front forward

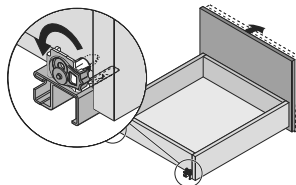

Drawer insertion

Extend the concealed runners fully. Place the drawer on the runners and close. The locking devices automatically engage with the runners. Make adjustments if necessary.

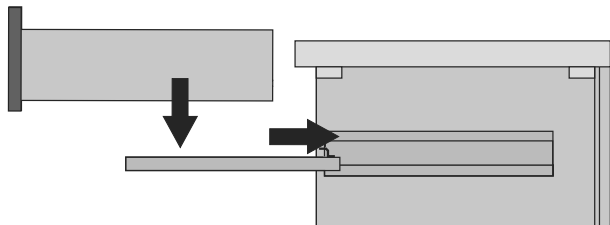

Drawer removal

- 1 Squeeze orange handles on locking devices
- 2 Pull drawer straight out and up

