

INSTALLATION GUIDE
Tryg Tables

April 1, 2017

TUOHY



Tryg Table Assembly
(One Piece Top)

TUOHY

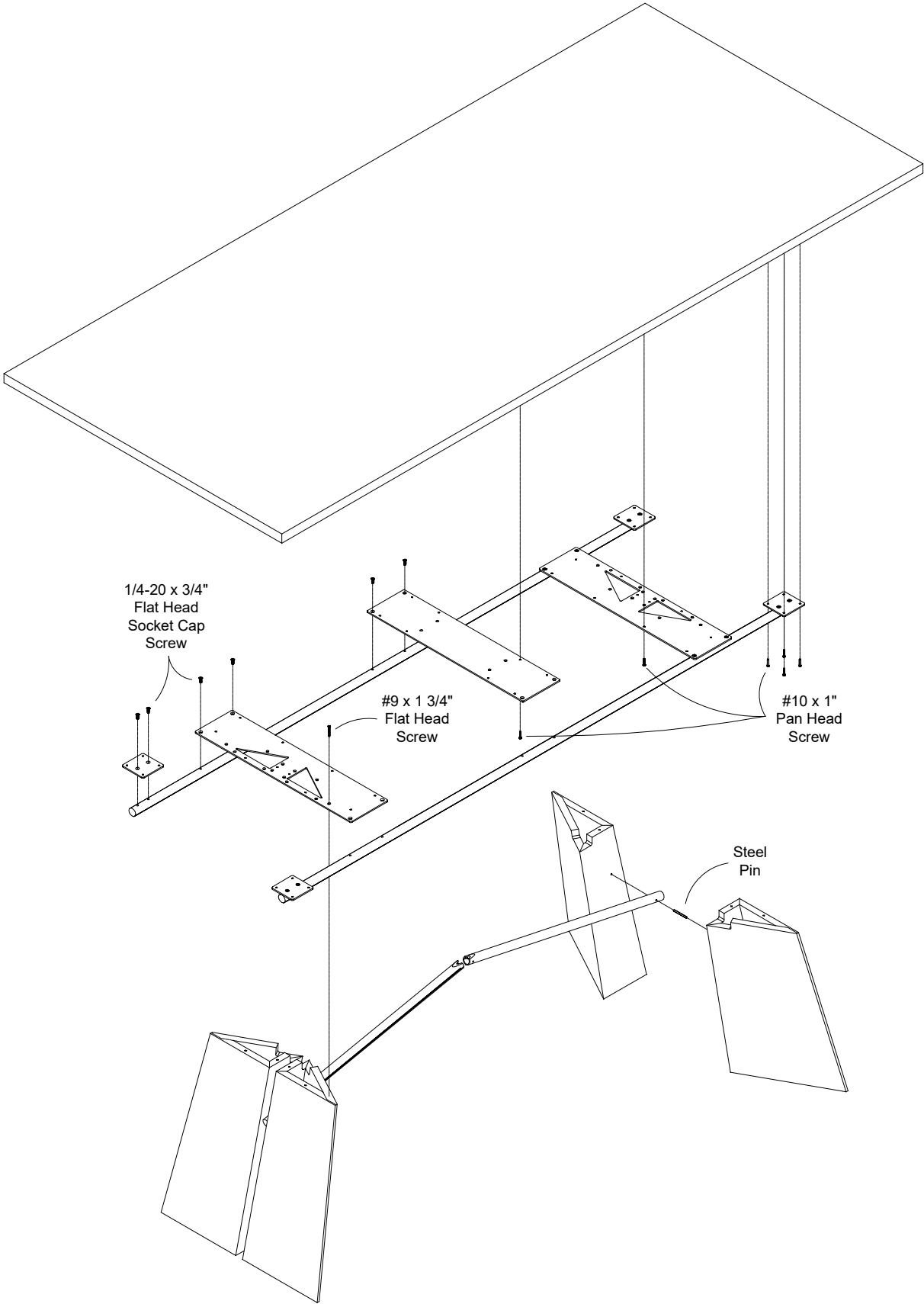

Base Assembly

TUOHY

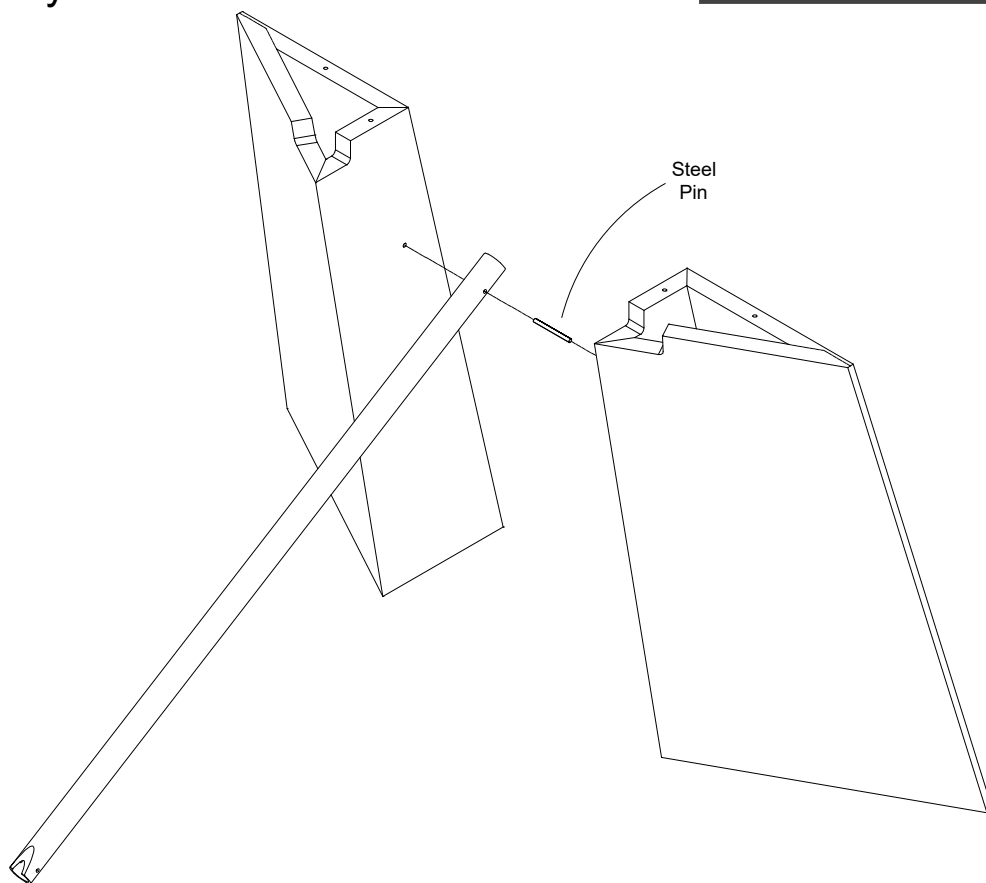

Use alignment pins (X4) to align base plate to base.
Predrill holes for #9 x 1 3/4" flat head screws.

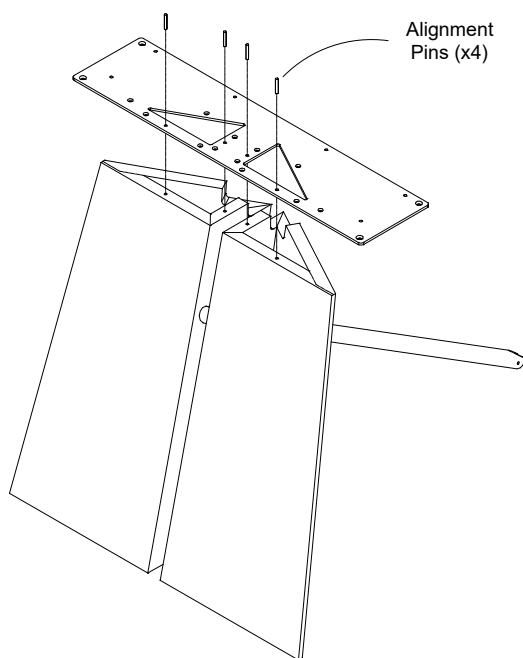

Screw base plate to base using
#9 x 1 3/4" flat head screws.
Remove alignment pins.

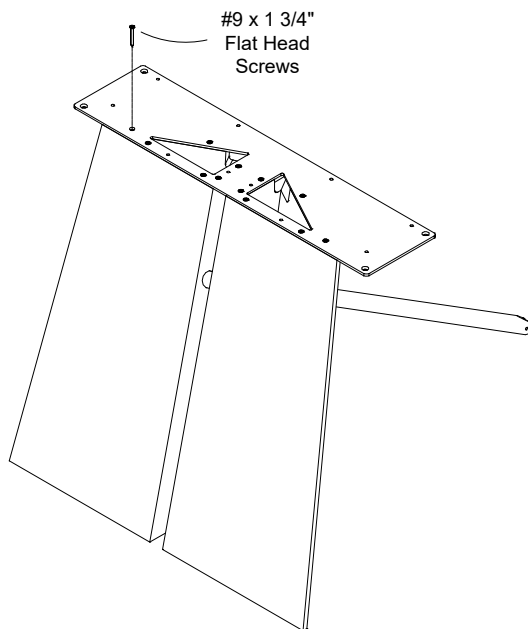

Metal Support Bar Attachment

Screw support bars to underside of base plates using 1/4-20 x 3/4" flat head socket cap screws.

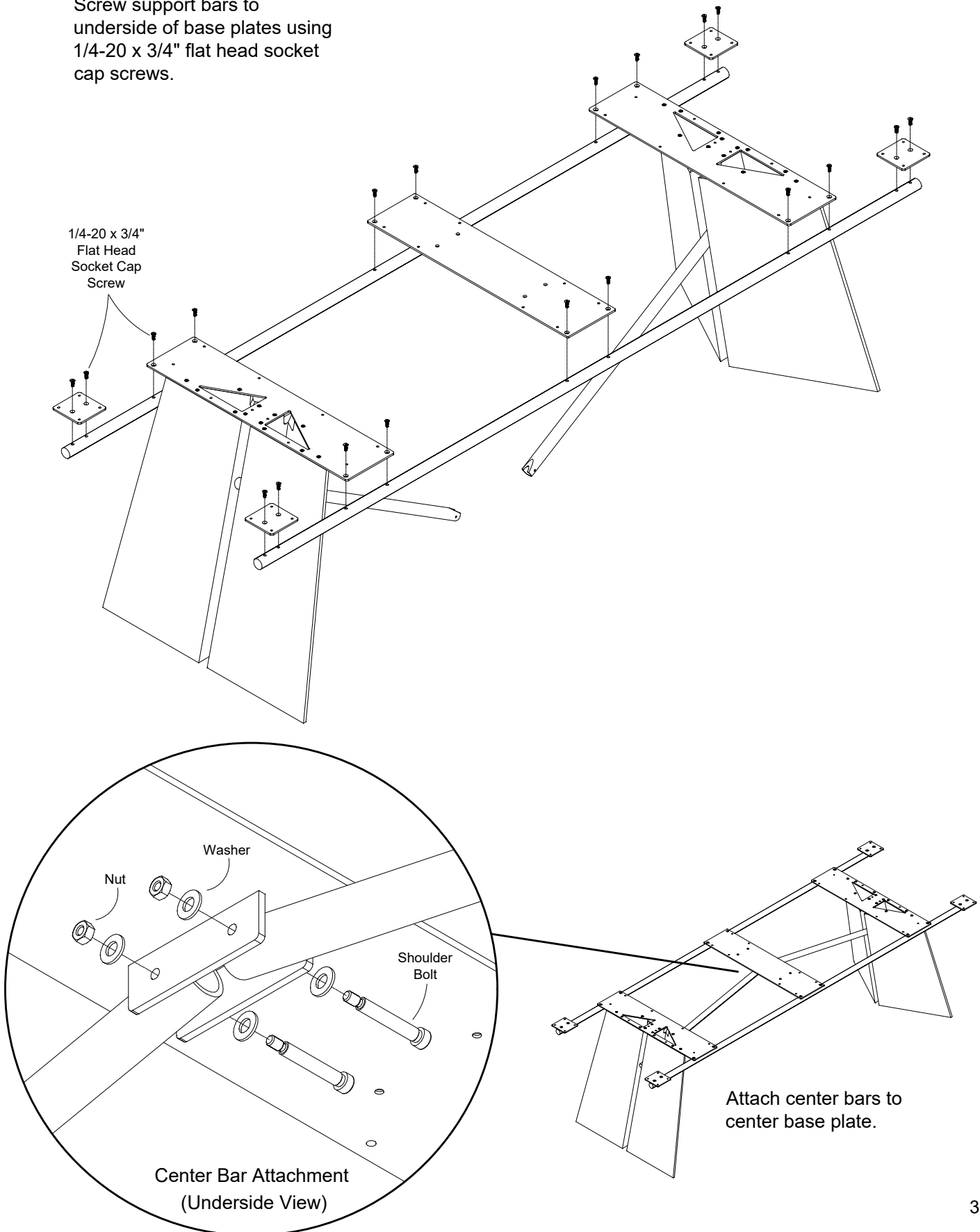

Top Attachment

Attach top using #10 x 1" Pan Head Screws.

TUOHY

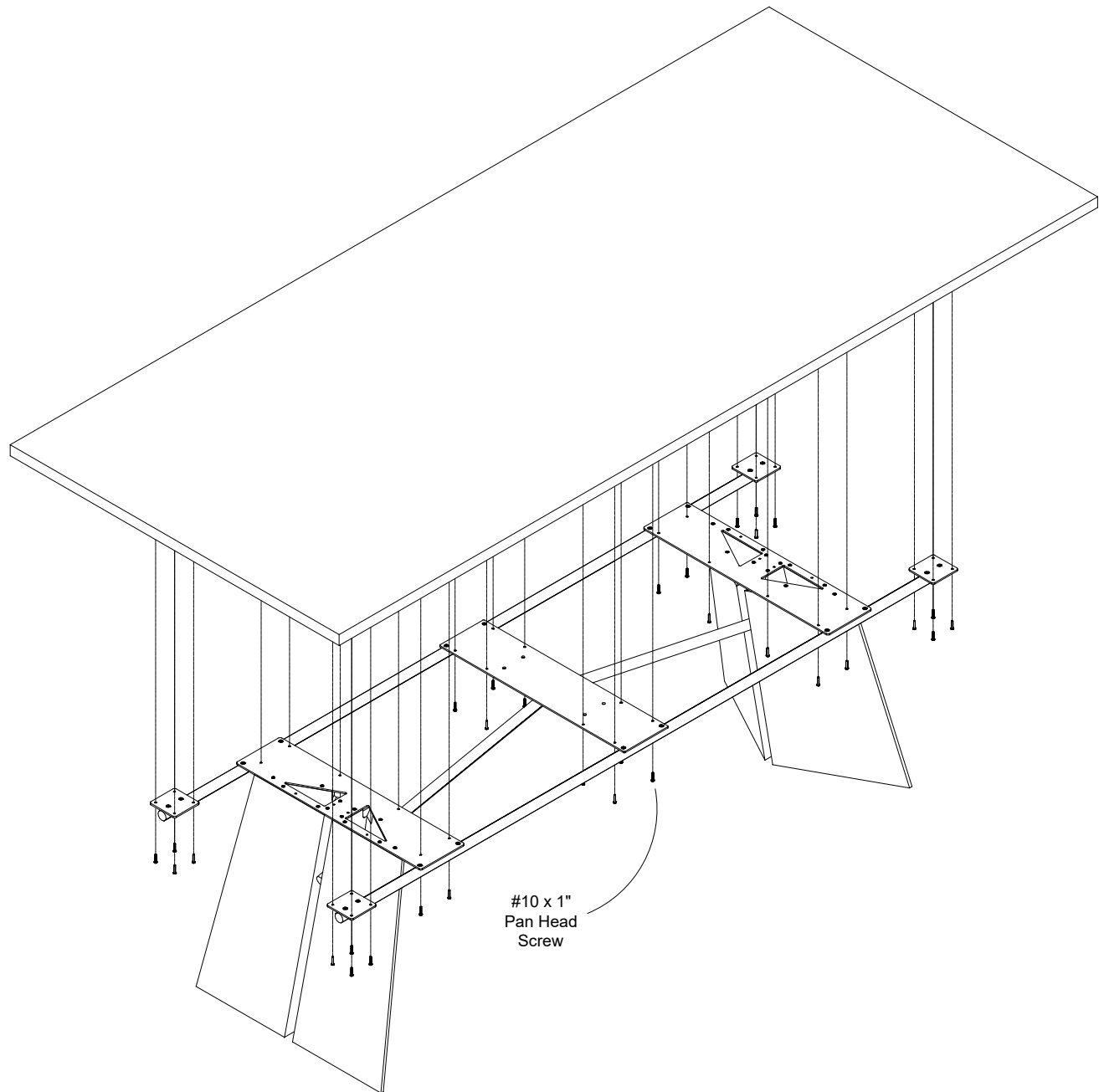

Tryg Table Assembly
(Two Piece Top and Center Base)

TUOHY

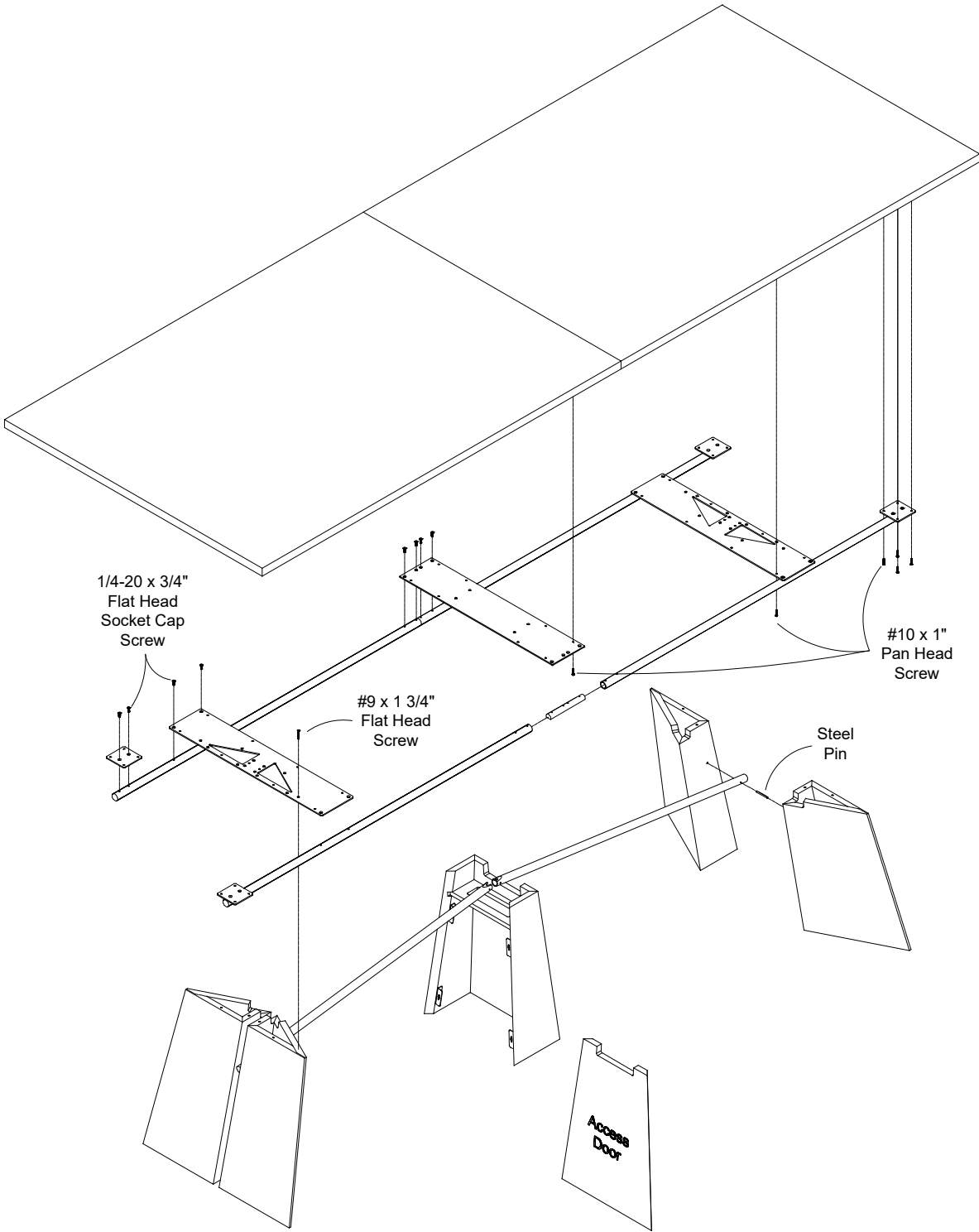

Base Assembly

TUOHY

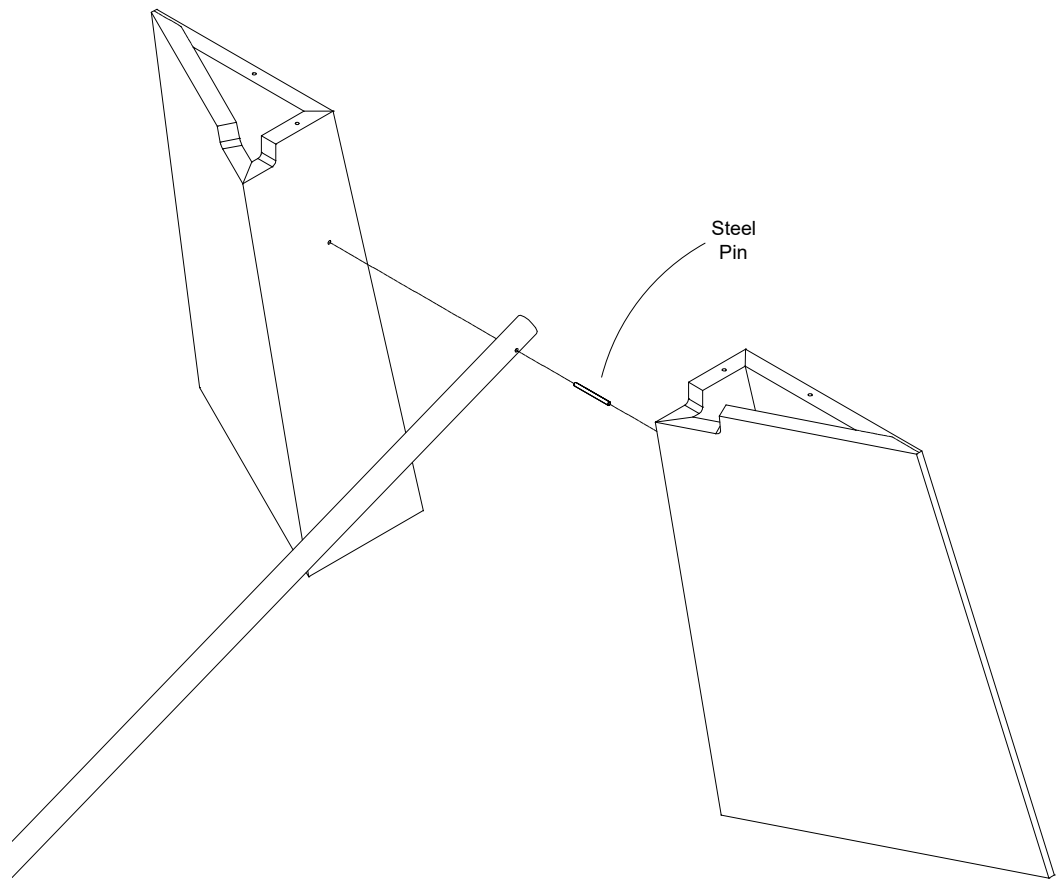

Use alignment pins (X4) to align base plate to base. Predrill holes for #9 x 1 3/4" flat head screws.

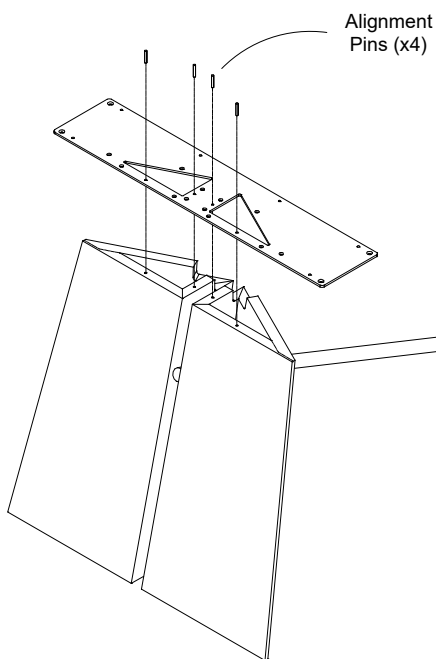

Screw base plates to bases using #9 x 1 3/4" flat head screws. Remove alignment pins.

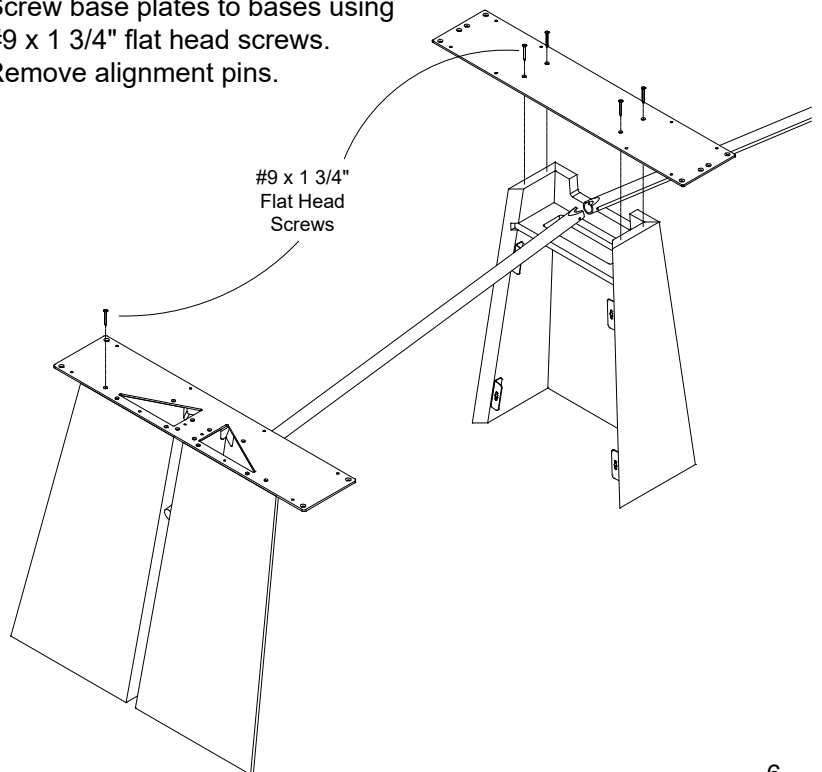

Metal Support Bar Attachment

Screw support bars to underside of base plates using 1/4-20 x 3/4" flat head socket cap screws.

1/4-20 x 3/4"
Flat Head
Socket Cap
Screw

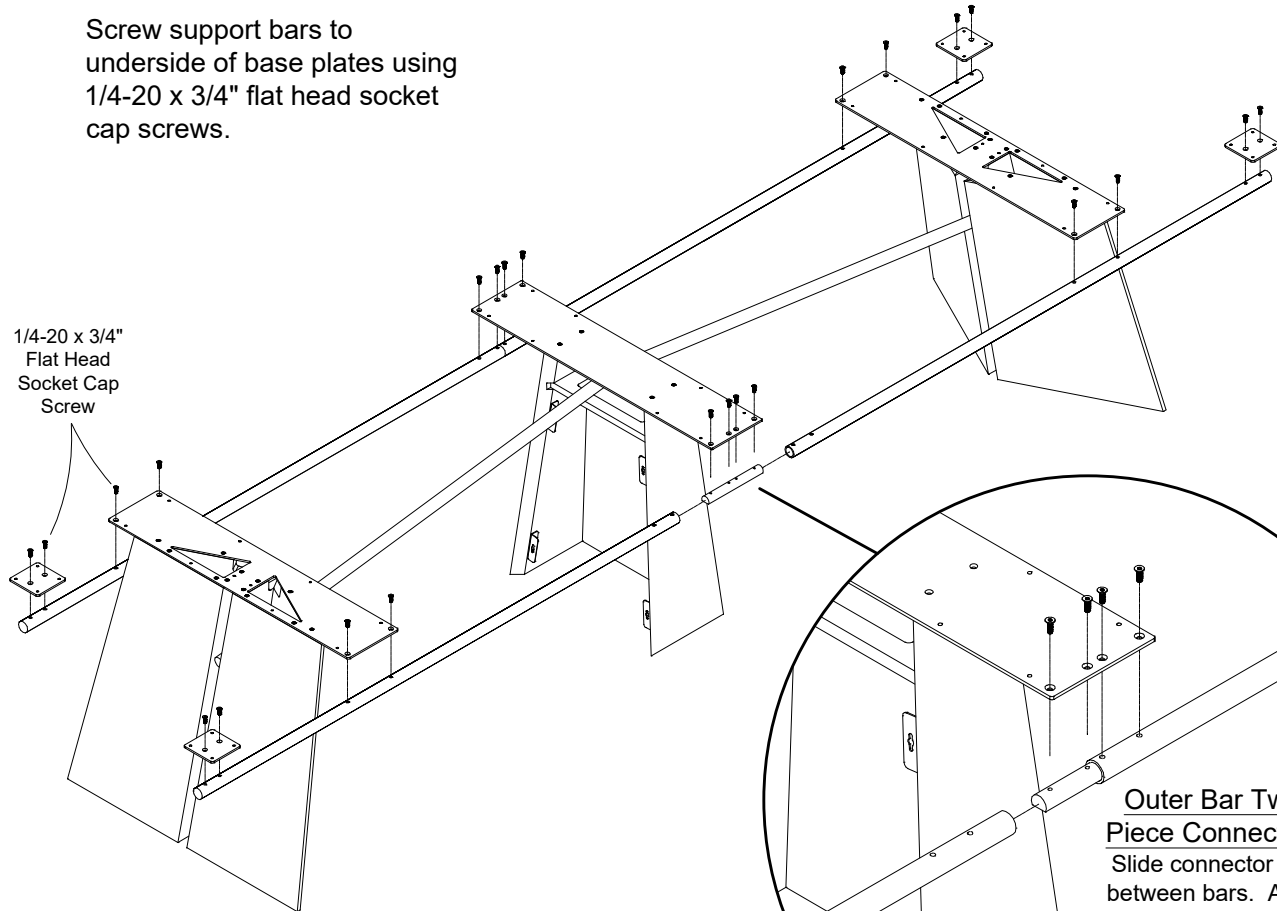

**Outer Bar Two
Piece Connection**
Slide connector bar
between bars. Align
holes. Screw to
underside of center
plate with 1/4-20 x 3/4"
flat head socket cap
screws

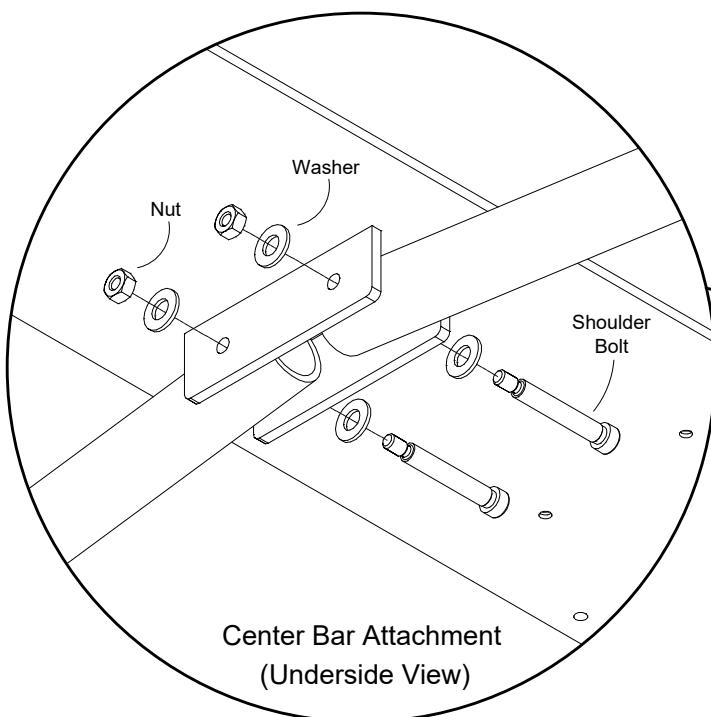

Center Bar Attachment
(Underside View)

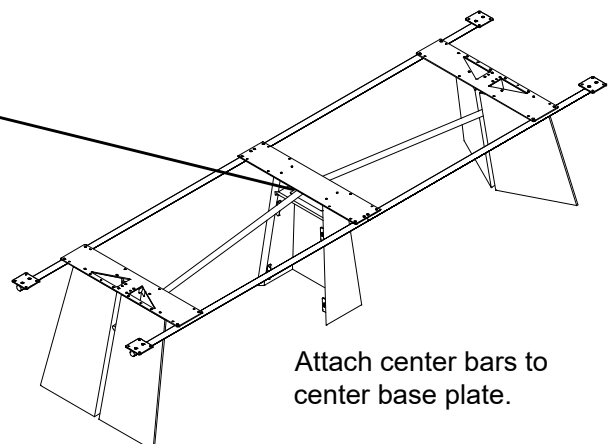

Attach center bars to
center base plate.

Top Attachment

Connect two piece top using joint connectors.
Attach top to base using #10 x 1" Pan Head Screws.

